

# **Grand Ledge Area Emergency Services Authority**

## **Regular Meeting Agenda**

January 19, 2026

6:00 pm

Meeting will be at

500 N. Clinton St. Grand Ledge MI, 48837

Training Room, Grand Ledge Fire Department

- I. **Roll Call of Authority Board** – Chairperson Don Willems, Vice Chairperson Keith Mulder, Treasurer Janet Schultz, Secretary Rick Lantz, Trustee Robert Stahelin II
- II. **Pledge of Allegiance**
- III. **Audience Participation** – Any person (s) attending may comment on any subject. All presentations before the Authority Board shall be limited to five minutes per individual presentation.
- IV. **Approval of Consent Agenda** – The Authority Board approves items listed on the consent agenda by a single roll call vote without debate. If the Authority Board desires to debate any item listed on the consent agenda, it may remove the item and place it on the regular agenda for consideration in due order.
  - A. Motion - To approve December 15, 2025, Regular Authority Board Meeting Minutes.
  - B. Motion - To approve December 22, 2025, Special Authority Board Meeting Minutes.
- V. **Approval of Regular agenda** – The Authority Board may remove any item or add any item to the regular agenda.
  - A. Motion – To approve the January 19, 2026, Regular Authority Board Meeting Agenda
- VI. **Committee and Board Reports** – Fire Authority Board members and staff may report on discussions and actions of committees and boards.
  - A. **Building Committee** – Veridus update – Katie Jacobs
  - B. **Finance Committee** –
  - C. **Truck/Equipment Replacement Committee** -
  - D. **Public Education Committee** –
  - E. **Personnel Committee** –
- VII. **Fire Chief/Staff Reports** – The Authority board may receive reports from the Chief, staff members, or contractors.
  - A. Monthly Run Activity
    1. Benton Rd house fire
  - B. Vehicle Report

- VIII. **Old Business** – The Authority board discusses any business unfinished from a previous meeting
- IX. **New Business** – The Authority Board may bring up for discussion any business not previously debated and may act or not act on the item(s) indicated.
- A. **Financial transactions and bills.**
1. Dec. 1, 2025 – Dec. 31, 2025
- X. **Audience Participation** – any person (s) attending may comment on any subject. All presentations before the Authority board shall be limited to five minutes per individual presentation.
- XI. **Communications from Authority Board members.**
- XII. **Closed session** – the Open Meetings Act allows the Authority board to discuss certain subjects without the presence of the public. The Authority Board may request a staff member or any other person the Authority Board determines to be necessary to attend the closed session. Once the closed session has ended, the Authority Board will resume the regular meeting.
- XIII. **Adjournment** – when the Fire Authority Board has completed all items listed on the approved agenda, it may not take any further action until its next regular meeting or a special meeting. If the time is significantly late and items remain on the approved agenda, the presiding officer may ask for a motion to adjourn the meeting to another specific date, time, and place at which to resume and complete the approved agenda.

October 30,

**GRAND LEDGE AREA EMERGENCY SERVICES AUTHORITY  
MEETING**

**DECEMBER 15, 2025**

**6:00 p.m.**

**AT 500 N. CLINTON STREET, GRAND LEDGE, MICHIGAN 48837**

1. Roll Call: Present: Chairman Willems, Secretary Lantz, Treasurer Schultz Vice Chair Mulder, Trustee Stahelin, Chief Roman. Also, Present were Members of Glaesa, and the Township and the Cty. and representing Veridus Katie Jacobs, representing Williams Architects Kim Nigro and Mark Bushhouse, The Christman Company represented by Rob Crowe and Jake Nelson,.
2. Pledge of Allegiance was given.
3. Audience Participation. Zack, told the Board of his feelings regarding the new health insurance and the cost share for the employees.
4. Approval of Consent Agenda: Motion was made by Mr. Stahelin and supported by Mr. Lantz. Motion Carried. October Minutes were approved in a motion made by Mr. Mulder and supported by Mr. Lantz. Motion Carried.
5. Approval of Regular Agenda. Motion was made by Mrs. Schultz and supported by Mr. Lantz to approve the Regular Agenda. Motion Carried.
6. Committee and Board Reports:
  - A. Building Committee: Veridus Update was presented by Katie Jacobs. She introduced the team working on the proposed new station and millage. She gave A Pre-Bond Services Update. The Agenda for the night included introductions, General Project Update, Existing Facility Condition Assessment, Initial Site Layout Concepts, Preliminary Cost Estimates and the Schedule and Budget. ( a copy is attached to these minutes.)

The General Update on the facilities assessment was a 1-2 with a scale of 4 being the best and 1 the worst. The current facility is not in good condition and the lot is too small. Also not having a decontamination site apart from the apparatus bay is not a good thing.

October 30,

She gave site plans and cost estimates for a New Main Station at the Clinton Street Site of 21, 883 sq. ft. option one and option two of 24,715 sq. ft. She also discussed Site Plans for New Satellite Station at the Clinton Street Site Plan of 11,400 sq. ft. and Site Plan Adaptive Reuse plan of 11,979 sq. ft.

She then discussed Initial Site Plan Layout Concepts for Hartel Road Site. Option one and two both would be 27,100 sq. ft. (see the attached report.)

The primary cost estimates for the above option for the new station at Hartel Road is \$18,51 million. For just one main station. Cost estimate for a satellite station and main station is 24.24 Million.

Katie gave the Scope / Schedule and Budget report for the coming months. Ending with a proposed May election for the project.

B. Finance Committee:

Audit Report as requested by the board for estimated future projected costs was given by Bethany Zerble. It outlined our budget for the next 6 years and shows that we have good financial planning for the future purchases that may be necessary.

The Annual Audit was presented by Ilie Thomanson of Maner Costarian. She reviewed with the Board the annual Audit and said we are good financial condition.

C. ISO REPORT: SKIP STARLING. Mr. Starling discussed the ISO Rating and how it effects the cost of home insurance and the need for a custom pumper to raise the ISO rating as well as using ponds for water supply. He also noted that the Chief would be tested.

D. No Action

October 30,

- E. Public Education: Chief noted that they would be working on the survey for the new station and educating people about the need for it.
- F. No action.

7. Fire Chief / Staff Reports.

A. Monthly Run Activity: EMS total runs 199. Fire Runs Total 75.

- 1. The new Ambulance will be here Friday. Then it will go out for outfitting and signage.

8. Old Business:

A. No action.

9. New Business:

10. Financial Statements and Bills November 1, 2025 to November 30, 2025. Motion was made by Mr. Stahelin and supported by Mr. Mulder to pay the bills as presented. Motion Carried.

1. Audience Participation: Mr. Weaver questioned the flexibility for growth at the Hartel site for the new station.

2. Communications from the Board. Mr. Mulder wanted to be sure the board realized the need for the Phase two survey of the Hartel Site. After discussion, Motion was made by Mr. Mulder to move forward with Phase 2 Survey and to authorize the chief to expend up to \$15,000.00 in additional monies for this project. Mr. Stahelin supported the motion. Motion Carried.

10 Motion to go into closed session was made by Mr. Mulder he moved that the Board meet in closed session under section 8 © of the open meetings act, for strategy sand negotiation sessions connected with the negotiation of a collective bargaining agreement as requested by the GLAESA Board. Roll Call Vote: Aye: Mrs. Schultz, Mr. Stahelin, Mr. Mulder, Mr. Lantz, Mr. Willems. Nay: None. Motion Carried,

October 30,

Motion to come out of closed session made by Mr. Lantz and supported by Mr. Mulder. Motion Carried. Motion made to adjourn at 9:35 p.m.

Minutes respectfully submitted by Jan Schultz.

APPROVED:

\_\_\_\_\_  
Mr. Don Willems, Chairman

\_\_\_\_\_  
Mr. Rick Lantz, Secretary

**GLAESA SPECIAL MEETING  
HELD DECEMBER 22, 2025  
AT 6:00 P.M.  
500 NORTH CLINTON**

PRESENT: CHAIRMAN WILLEMS, SECRETARY LANTZ, TREASURER SCHULTZ, (VICE CHAIR MULDER ON ZOOM), TRUSTEE STAHELIN, FIRE CHIEF ROMAN

2. Pledge of Allegiance was given:
3. Audience Participation: There was none.
4. Approval of Consent Agenda: there was none.
5. Approval of Special Meeting Agenda: Approval was given to the Agenda in a Motion made by Mr. Lantz and supported by Mr. Stahelin. Motion Carried.

Board then moved to Old Business: Resolution #16-2025, A Resolution to Exempt the Grand Ledge Area Emergency Services Authority from the requirements of 2011 Public Act 152, The Publicly funded Health Insurance Contribution Act, And to Approve the 2026 Employee Health Care Plans for the Plan Year January 1, 2026 Through December 31, 2026. This Resolution was offered by Mr. Lantz and supported by Mr. Stahelin. Roll Call Vote: Aye: Mrs. Schultz, M. Stahelin, Mr. Lantz, Mr. Willems. Nay: None. Excused: Mr. Mulder. Resolution Adopted.

The Memorandum of Understanding was presented to the Board from the Union.

Chairman asked for Audience Participation. There was none.

Chairman asked for Board Communications: He wished every one a Merry Christmas and to be safe.

Meeting was adjourned at 6:15 p.m.

---

Mr. Don Willems, Chairman

Mr. Rick Lantz, Secretary

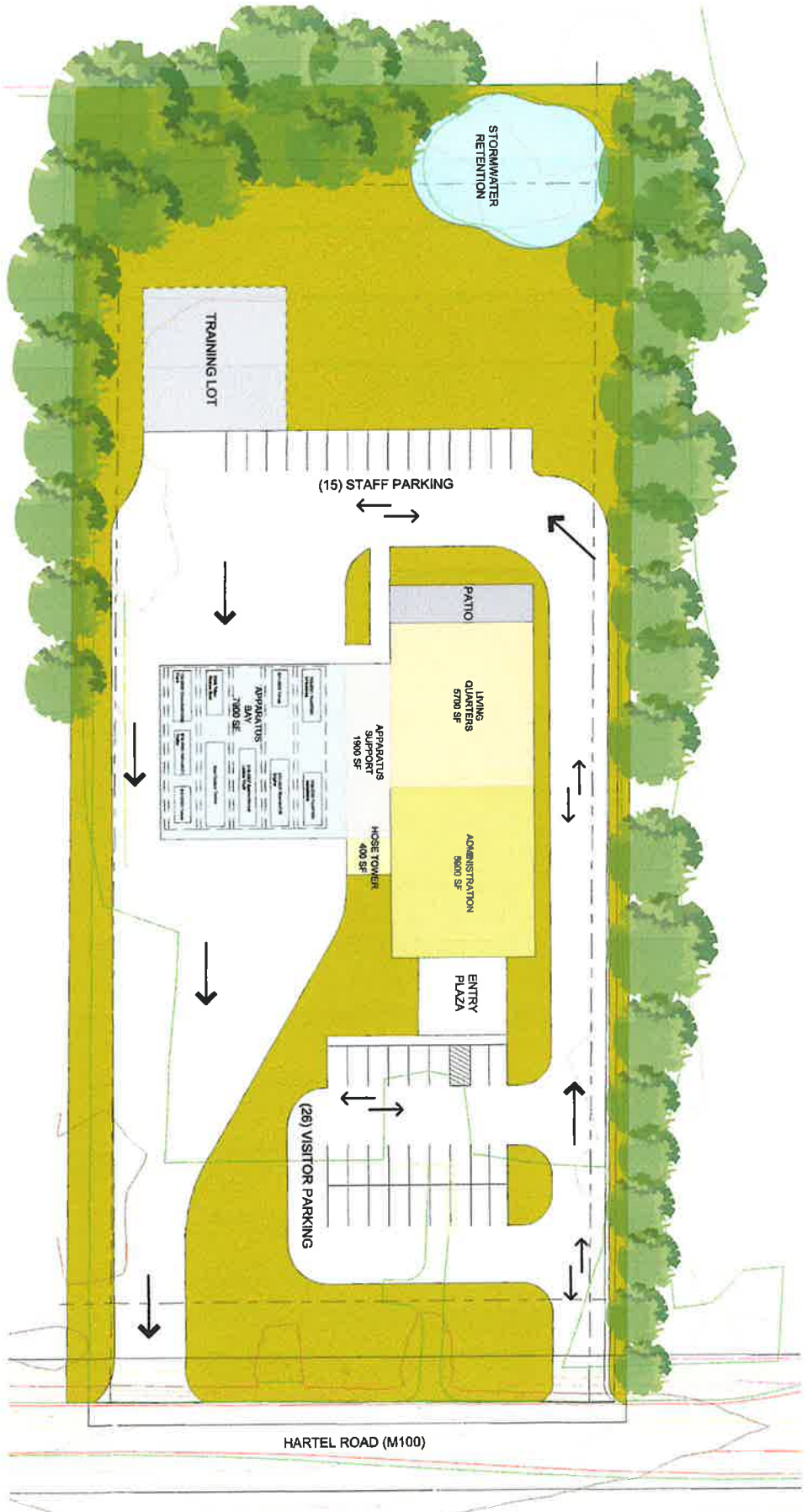

**1 PLAN** SITE PLAN - UPDATE  
SCALE: 1" = 50'-0"



**NEW MAIN STATION** 11485 N HARTEL ROAD, GRAND LEDGE, MI  
**GRAND LEDGE AREA EMERGENCY SERVICES - FIRE STATION**

**A102**

2025-055  
2026 01 14  
williamsarchitects.com  
COPYRIGHT © 2025  
williamsarchitects@fridrichs.net



**Grand Ledge Emergency Services Authority Bond Proposal**

Shall the Grand Ledge Emergency Services Authority, County of Eaton, Michigan, borrow the principal sum of not to exceed Twenty Million Five Hundred Thousand Dollars (\$20,500,000) and issue its general obligation unlimited tax bonds, in one or more series, payable in not to exceed twenty (20) years from the date of issue of each series, for the purpose of paying the cost to acquire, construct, furnish and equip a new fire station, renovate, furnish and equip the existing fire station, and acquire fire apparatus, together with site improvements, including interests in land, necessary rights-of-way and appurtenances and attachments thereto?

YES

NO

If approved, the estimated millage to be levied in 2026 is      mills (\$      per \$1,000 of taxable value) and the estimated simple average annual millage rate required to retire the bonds is      mills (\$      per \$1,000 of taxable value).

---

Need:

First year estimated millage     

Simple average annual millage     

Deadline to certify to township and city clerk: 4pm Tuesday February 10<sup>th</sup>



Baker Tilly Municipal Advisors, LLC  
1000 Town Center, 27<sup>th</sup> Floor  
Southfield, MI 48075  
(517) 321-0110  
bakertilly.com

January 16, 2026

Grand Ledge Area Emergency Services Authority  
500 North Clinton Street  
Grand Ledge, MI 48837

Re: Estimated Voted Bond Analysis

The attached schedules (listed below) present unaudited and limited information for the purpose of discussion and consideration in the planning stage of a proposed capital improvement plan by the appropriate officers, officials and advisors of Grand Ledge Area Emergency Services Authority. The use of the schedules should be restricted to this purpose, for internal use only as the information is subject to future revision and final report.

Page(s)

PRO FORMA FINANCIAL DATA

- |   |   |
|---|---|
| 2 | Taxable Value History and Growth Assumptions                      |
| 3 | Capital Improvement Plan  |
| 4 | Comparison of Estimated Debt Service Millage Rates – Chart Format |
| 5 | Estimated Proposed Total Millage Study - \$20,595,000 – 20 Years  |

We would appreciate your questions or comments on this information and would provide additional information upon request.

BAKER TILLY MUNICIPAL ADVISORS, LLC

Jesse R. Nelson, CPA, Partner

**GRAND LEDGE AREA EMERGENCY SERVICES AUTHORITY  
COUNTY OF EATON, STATE OF MICHIGAN**

**TAXABLE VALUE HISTORY AND GROWTH ASSUMPTIONS**

| <u>Year</u> | <u>Taxable Value</u> | <u>Total Value</u> |       |
|-------------|----------------------|--------------------|-------|
| 2025        | 528,381,315          | 528,381,315        | 2.89% |
| 2024        | 513,528,271          | 513,528,271        | 6.82% |
| 2023        | 480,733,475          | 480,733,475        | 6.70% |
| 2022        | 450,555,713          | 450,555,713        | 6.87% |
| 2021        | 421,605,811          | 421,605,811        | 5.23% |
| 2020        | 400,659,777          | 400,659,777        | 2.42% |
| 2019        | 391,197,747          | 391,197,747        | 5.01% |
| 2018        | 372,520,955          | 372,520,955        | 1.98% |
| 2017        | 365,284,245          | 365,284,245        | 2.62% |
| 2016        | 355,948,203          | 355,948,203        |       |

5-Year History Average

5.70%

10-Year History Average

4.50%

(Subject to the attached letter dated January 16, 2026)  
(Preliminary - Subject to Change)  
(Internal Use Only)

**GRAND LEDGE AREA EMERGENCY SERVICES AUTHORITY  
COUNTY OF EATON, STATE OF MICHIGAN**

**CAPITAL IMPROVEMENT PLAN**

**I. Debt Service Millage Rate** **\$20,595,000**  
**20-Year**  
Option

|   |          |
|---|----------|
| Estimated 12/1/2026 tax bill  | 2.81     |
| Estimated 12/1/2025 tax bill  | -        |
| Difference  | 2.81     |
| Annual difference \$100,000 market value<br>\$50,000 taxable value property | \$140.50 |
| Per Month   | \$11.71  |

**II. Proposal Summary**

| <u>2026 Bonds</u>        | <u>2026</u>         |
|--------------------------|---------------------|
| Construction             | <b>\$20,500,000</b> |
| Underwriting allowance   | 205,950             |
| Bond issuance costs      | 179,562             |
| Less interest income [1] | (290,512)           |
| Par amount of bonds      | \$20,595,000        |

[1] Assumes 24 month draw schedule at an assumed interest rate of 1.50%

(Subject to the attached letter dated January 16, 2026)  
(Preliminary - Subject to Change)  
(Internal Use Only)

**GRAND LEDGE AREA EMERGENCY SERVICES AUTHORITY  
COUNTY OF EATON, STATE OF MICHIGAN**

**COMPARISON OF ESTIMATED DEBT SERVICE MILLAGE RATES - CHART FORMAT**  
(Assumes taxable value growth of 2.25%)

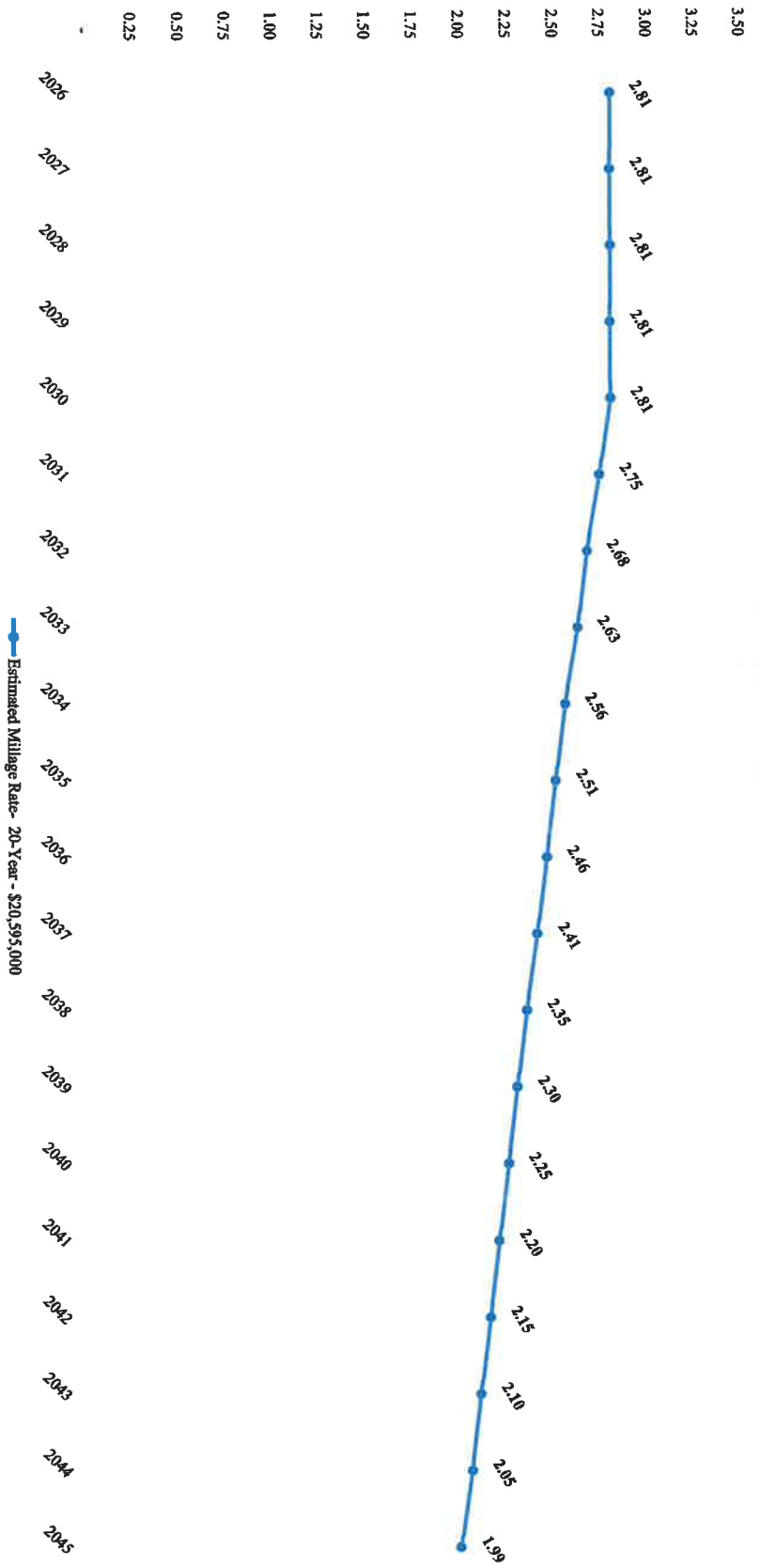

(Subject to the attached letter dated January 16, 2026)  
(Preliminary - Subject to Change)  
(Internal Use Only)

**GRAND LEDGE AREA EMERGENCY SERVICES AUTHORITY  
COUNTY OF EATON, STATE OF MICHIGAN**

**ESTIMATED PROPOSED TOTAL MILLAGE STUDY - \$20,595,000 - 20 YEARS**

Winter Tax Levy

Tax Collection Fac 100%

\*Significant assumptions

| Taxable Value Year | Debt Service Year Ending | Growth % | Taxable Value | Revenues                    |                             | Total Millage Rate | Tax Collections | PPT Reimbursements | Total Revenues | Bond Payments           |                           |                       | Debt Retirement Fund |                      |                  |
|--------------------|--------------------------|----------|---------------|-----------------------------|-----------------------------|--------------------|-----------------|--------------------|----------------|-------------------------|---------------------------|-----------------------|----------------------|----------------------|------------------|
|                    |                          |          |               | Existing Bonds Millage Rate | Proposed Bonds Millage Rate |                    |                 |                    |                | Existing Bonds Payments | Proposed Bonds 2026 Bonds | Total Annual Payments |                      | Increase/ (Decrease) | Dec. 1st Balance |
| 2025               | 2026                     | 2.89%    | 528,381,315   | -                           | -                           | 2.81               | \$0             | \$0                | \$0            | \$0                     | \$0                       | \$0                   | \$0                  | 127,442              | 127,442          |
| 2026               | 2027                     | 2.25%    | 540,269,895   | -                           | 2.81                        | 2.81               | 1,518,158       | -                  | 1,518,158      | 1,390,716               | 1,390,716                 | 1,390,716             | 127,442              | (1,723)              | 125,719          |
| 2027               | 2028                     | 2.25%    | 552,425,968   | -                           | 2.81                        | 2.81               | 1,532,317       | -                  | 1,532,317      | 1,554,040               | 1,554,040                 | 1,554,040             | 1,390,716            | 1,851                | 127,570          |
| 2028               | 2029                     | 2.25%    | 564,855,552   | -                           | 2.81                        | 2.81               | 1,587,244       | -                  | 1,587,244      | 1,585,393               | 1,585,393                 | 1,585,393             | 1,554,040            | (888)                | 126,682          |
| 2029               | 2030                     | 2.25%    | 577,564,802   | -                           | 2.81                        | 2.81               | 1,622,957       | -                  | 1,622,957      | 1,623,845               | 1,623,845                 | 1,623,845             | 1,585,393            | 386                  | 127,068          |
| 2030               | 2031                     | 2.25%    | 590,560,010   | -                           | 2.81                        | 2.81               | 1,659,474       | -                  | 1,659,474      | 1,659,088               | 1,659,088                 | 1,659,088             | 1,623,845            | (1,009)              | 126,059          |
| 2031               | 2032                     | 2.25%    | 603,847,610   | -                           | 2.75                        | 2.75               | 1,660,581       | -                  | 1,660,581      | 1,661,590               | 1,661,590                 | 1,661,590             | 1,659,088            | (2,231)              | 123,828          |
| 2032               | 2033                     | 2.25%    | 617,434,181   | -                           | 2.63                        | 2.63               | 1,654,724       | -                  | 1,654,724      | 1,656,955               | 1,656,955                 | 1,656,955             | 1,661,590            | 379                  | 124,207          |
| 2033               | 2034                     | 2.25%    | 631,326,450   | -                           | 2.56                        | 2.56               | 1,660,389       | -                  | 1,660,389      | 1,660,010               | 1,660,010                 | 1,660,010             | 1,656,955            | (3,023)              | 121,184          |
| 2034               | 2035                     | 2.25%    | 645,531,295   | -                           | 2.51                        | 2.51               | 1,652,560       | -                  | 1,652,560      | 1,655,583               | 1,655,583                 | 1,655,583             | 1,660,010            | 1,853                | 121,292          |
| 2035               | 2036                     | 2.25%    | 660,055,749   | -                           | 2.46                        | 2.46               | 1,656,740       | -                  | 1,656,740      | 1,658,485               | 1,658,485                 | 1,658,485             | 1,655,583            | (1,745)              | 119,439          |
| 2036               | 2037                     | 2.25%    | 674,907,003   | -                           | 2.41                        | 2.41               | 1,660,271       | -                  | 1,660,271      | 1,658,418               | 1,658,418                 | 1,658,418             | 1,658,485            | 2,948                | 124,240          |
| 2037               | 2038                     | 2.25%    | 690,092,411   | -                           | 2.35                        | 2.35               | 1,658,206       | -                  | 1,658,206      | 1,660,175               | 1,660,175                 | 1,660,175             | 1,658,418            | (342)                | 123,898          |
| 2038               | 2039                     | 2.25%    | 705,619,490   | -                           | 2.25                        | 2.25               | 1,659,892       | -                  | 1,659,892      | 1,658,548               | 1,658,548                 | 1,658,548             | 1,660,175            | 1,126                | 125,024          |
| 2039               | 2040                     | 2.25%    | 721,495,929   | -                           | 2.20                        | 2.20               | 1,659,441       | -                  | 1,659,441      | 1,658,315               | 1,658,315                 | 1,658,315             | 1,658,548            | 762                  | 125,786          |
| 2040               | 2041                     | 2.25%    | 737,729,587   | -                           | 2.15                        | 2.15               | 1,659,297       | -                  | 1,659,297      | 1,655,755               | 1,655,755                 | 1,655,755             | 1,658,315            | 3,768                | 129,554          |
| 2041               | 2042                     | 2.25%    | 754,328,503   | -                           | 2.10                        | 2.10               | 1,656,176       | -                  | 1,656,176      | 1,657,815               | 1,657,815                 | 1,657,815             | 1,655,755            | 482                  | 130,036          |
| 2042               | 2043                     | 2.25%    | 771,300,894   | -                           | 2.05                        | 2.05               | 1,653,120       | -                  | 1,653,120      | 1,651,813               | 1,651,813                 | 1,651,813             | 1,657,815            | 1,307                | 131,287          |
| 2043               | 2044                     | 2.25%    | 788,655,164   | -                           | 1.99                        | 1.99               | 1,640,842       | -                  | 1,640,842      | 1,643,200               | 1,643,200                 | 1,643,200             | 1,651,813            | (2,358)              | 130,236          |
| 2044               | 2045                     | 2.25%    | 806,399,905   | -                           | 49.44                       | 49.44              | \$32,794,035    | \$0                | \$32,794,035   | \$32,663,799            | \$32,663,799              | \$32,663,799          | 1,643,200            |                      |                  |
| 2045               | 2046                     | 2.25%    | 824,543,903   | -                           |                             |                    |                 |                    |                |                         |                           |                       |                      |                      |                  |
| Totals             |                          |          |               |                             |                             |                    |                 |                    |                |                         |                           |                       |                      |                      |                  |

\$20,595,000      \$20,595,000  
 \$12,068,799      \$12,068,799  
3.50% - 5.40%

(Subject to the attached letter dated January 16, 2026)  
 (Preliminary - Subject to Change)  
 (Internal Use Only)



## Eaton County Central Dispatch

911 Courthouse Dr. | Charlotte MI 48813  
Phone: 517-543-4913 | Fax: 517-543-3036

Kelley Flynn, *Director*  
Francis D'Huyvetter, *Deputy Director*

### Monthly Report: December 2025

#### Monthly Statistics:

- Total Telephone Calls: **8,657**
  - Emergency Lines: **3,535**
  - Non-Emergency Lines: **5,122**
- Text-to-911 Sessions: **43**
- Total Incidents: **7,710**
  - EMS: **1,598**
  - Fire: **961**
  - Law Enforcement: **5,151**
- Addresses Issued: **4**
- Radio Support Tickets: **4**
- RAVE Mobile Safety
  - Smart911 Safety Profile Activity: **26**
  - Smart911 Safety Profiles Created: **28**
  - RAVE Facility Profile Activity: **55**
  - RAVE Facility Profiles Created: **0**
  - RAVE Panic Button Activity: **2**

#### Training & Exercise:

- Telecommunicator Brown attended *Introduction to the Fire Services* at Oakland Community College.
- Telecommunicator LaLone attended *Advanced 40-Hour Dispatch School* hosted by Eaton County Central Dispatch, a state-mandated training.
- Director Flynn, Supervisor Jones, Supervisor Neirink, Telecommunicator DeClercq, and Telecommunicator Ferry participated in night scenarios with the Mid-Michigan Police Academy at Lansing Community College.

#### Facility Projects:

- None

#### Technology & Radios:

- **Current Projects in Progress:**
  - ASAP to PSAP
  - Eaton911 Connect App
  - Radio Encryption
  - Unify CAD-to-CAD
  - PowerDMS Vitals

#### Communications Unit Support:

- **Events/Exercises:**
  - 2025 Grand Ledge Christmas Parade
  - 2025 Eaton Rapids Christmas Parade

- **Incident Radio Communication Plans Created:**
  - 2025 Eaton Rapids Christmas Parade

### **Operations:**

- The monthly test of the Outdoor Warning Sirens was conducted on December 6<sup>th</sup>.
- There is one (1) applicant in the background phase of the hiring process and three (3) applicants on the hiring waitlist.
- Deputy Director D'Huyvetter attended the Eaton County Chiefs of Police meeting.
- Telecommunicator LaLone successfully completed the training program.
- Yearly evaluations are in progress.

### **Operational Staffing Report:**

- **Public Safety Telecommunicators**
  - Fully Trained: 15
  - In Training: 0
  - Vacant: 1
- **Supervisors**
  - Fully Trained: 6
  - In Training: 0
  - Vacant: 0

### **Outreach & Public Relations Events:**

- The Public Relations Team participated in the City of Pottersville's Christmas Parade.

Yours Truly,



Kelley Flynn  
Director



# Eaton County Central Dispatch

## Total Calls For Service

| December 2025      |               |               |               |               |
|--------------------|---------------|---------------|---------------|---------------|
| Type Agency        | Month To Date |               | Year To Date  |               |
|                    | Calls         | %/Total       | Calls         | %/Total       |
| EMS                | 1,598         | 20.7%         | 19,365        | 29.9%         |
| Fire               | 961           | 12.5%         | 10,958        | 16.9%         |
| Police             | 5,151         | 66.8%         | 34,542        | 53.3%         |
| <b>Total Calls</b> | <b>7,710</b>  | <b>100.0%</b> | <b>64,865</b> | <b>100.0%</b> |

# Eaton County Central Dispatch EMS Calls For Service

| December 2025   |               |               |               |               |
|---|---------------|---------------|---------------|---------------|
| Agency  | Month To Date |               | Year To Date  |               |
|   | Calls         | %/Total       | Calls         | %/Total       |
| Benton Twp. EMS   | 77            | 4.8%          | 890           | 4.6%          |
| Delta Twp. EMS  | 564           | 35.3%         | 6,527         | 33.7%         |
| Eaton Area EMS  | 609           | 38.1%         | 7,627         | 39.4%         |
| Grand Ledge EMS   | 174           | 10.9%         | 2,235         | 11.5%         |
| Vermontville EMS  | 14            | 0.9%          | 232           | 1.2%          |
| Windsor Twp. EMS  | 100           | 6.3%          | 1,218         | 6.3%          |
| Outside Agencies*<br><i>DLHE (0), LIFE(0), LTEM(16),<br/>NEMS(9), PRTE(35), LAEM(0)</i> | 60            | 3.8%          | 636           | 3.3%          |
| <b>Total EMS Calls</b>  | <b>1,598</b>  | <b>100.0%</b> | <b>19,365</b> | <b>100.0%</b> |

\* Agencies Outside Eaton County

# Eaton County Central Dispatch Fire Calls For Service

| December 2025                             |               |               |               |               |
|---|---------------|---------------|---------------|---------------|
| Agency                                    | Month To Date |               | Year To Date  |               |
|   | Calls         | %/Total       | Calls         | %/Total       |
| Bellevue Fire                             | 30            | 3.1%          | 360           | 3.3%          |
| Benton Twp Fire                           | 19            | 2.0%          | 315           | 2.9%          |
| Charlotte Fire                            | 196           | 20.4%         | 2,046         | 18.7%         |
| Delta Fire                                | 307           | 31.9%         | 3,755         | 34.3%         |
| Eaton Rapids City                         | 70            | 7.3%          | 830           | 7.6%          |
| Eaton Rapids Twp.                         | 70            | 7.3%          | 815           | 7.4%          |
| Grand Ledge Fire                          | 88            | 9.2%          | 954           | 8.7%          |
| Hamlin Twp Fire                           | 22            | 2.3%          | 221           | 2.0%          |
| Olivet Fire                               | 33            | 3.4%          | 303           | 2.8%          |
| Roxand Twp. Fire                          | 17            | 1.8%          | 171           | 1.6%          |
| Sunfield Fire                             | 47            | 4.9%          | 367           | 3.3%          |
| Vermontville Fire                         | 9             | 0.9%          | 118           | 1.1%          |
| Windsor Fire                              | 44            | 4.6%          | 576           | 5.3%          |
| Outside Agencies*                         | 9             | 0.9%          | 127           | 1.2%          |
| <i>LTFD(9), LAFD(0), DLHF(0), NASH(0)</i> |               |               |               |               |
| <b>Total Fire Calls</b>                   | <b>961</b>    | <b>100.0%</b> | <b>10,958</b> | <b>100.0%</b> |

\* Agencies Outside Eaton County

# Eaton County Central Dispatch

## Police Calls For Service

| December 2025                               |               |               |               |               |
|---|---------------|---------------|---------------|---------------|
| Agency                                      | Month To Date |               | Year To Date  |               |
|   | Calls         | %/Total       | Calls         | %/Total       |
| Bellevue Police                             | 32            | 0.6%          | 311           | 0.9%          |
| Charlotte Police                            | 604           | 11.7%         | 7,342         | 21.3%         |
| Eaton County Sheriff                        | 2,170         | 42.1%         |               | 0.0%          |
| <i>Delta</i>                                | 1,807         | 35.1%         | 21,704        | 62.8%         |
| <i>Out County</i>                           | 363           | 7.0%          | 7,199         | 20.8%         |
| <i>Animal Control</i>                       | 26            | 0.5%          | 756           | 2.2%          |
| Eaton Rapids Police                         | 299           | 5.8%          | 3,991         | 11.6%         |
| Grand Ledge Police                          | 524           | 10.2%         | 5,054         | 14.6%         |
| Michigan State Police                       | 1,330         | 25.8%         | 15,655        | 45.3%         |
| Olivet Police                               | 53            | 1.0%          | 329           | 1.0%          |
| Pottersville Police                         | 101           | 2.0%          | 1,537         | 4.4%          |
| Outside Agencies*<br><i>ME(17), DNR(21)</i> | 38            | 0.7%          | 323           | 0.9%          |
| <b>Total Police Calls</b>                   | <b>5,151</b>  | <b>100.0%</b> | <b>34,542</b> | <b>100.0%</b> |

| <b>Eaton County 911 Phone Calls Received in 2025</b> |               |                      |                    |
|--|---------------|----------------------|--------------------|
| <b>Month</b>   | <b>911</b>    | <b>Non-emergency</b> | <b>Total Calls</b> |
| <b>January</b>                                       | 3,421         | 5,159                | 8,580              |
| <b>February</b>                                      | 3,157         | 4,847                | 8,004              |
| <b>March</b>   | 3,816         | 5,973                | 9,789              |
| <b>April</b>   | 3,654         | 5,755                | 9,409              |
| <b>May</b>   | 4,585         | 5,824                | 10,409             |
| <b>June</b>  | 4,128         | 6,117                | 10,245             |
| <b>July</b>  | 3,987         | 5,996                | 9,983              |
| <b>August</b>  | 4,059         | 5,601                | 9,660              |
| <b>September</b>                                     | 3,608         | 5,578                | 9,186              |
| <b>October</b>                                       | 3,909         | 5,894                | 9,803              |
| <b>November</b>                                      | 3,540         | 5,250                | 8,790              |
| <b>December</b>                                      | 3,535         | 5,122                | 8,657              |
| <b>TOTAL</b>   | <b>45,399</b> | <b>67,116</b>        | <b>112,515</b>     |

**Eaton County New Builds**

| <b>Date Issued</b> | <b>Certificate #</b> | <b>New Address</b> | <b>City</b> | <b>Zip Code</b> | <b>Permit Type</b> |
|--------------------|----------------------|--------------------|-------------|-----------------|--------------------|
| December 3, 2025   | 2025-70              | 2400 ENA DR        | LANSING     | 48917           | COMMERCIAL         |
| December 4, 2025   | 2025-69              | 11701 HIGHLAND CT  | DIMONDALE   | 48821           | NEW BUILD          |
| December 8, 2025   | 2025-71              | 3338 S BRADLEY RD  | CHARLOTTE   | 48813           | ELECTRICAL ONLY    |
| December 30, 2025  | 2025-72              | 5520 ELM RD        | OLIVET      | 49076           | ACCESSORY BUILDING |

# EATON COUNTY 911

## Events by Nature Code by Agency

Agency: GEMS, Event date/Time range: 12/01/2025 00:00:00 - 12/31/2025 23:59:59

| Agency Code | Nature Code                    | Rpt Only | Self Init | CFS | Total | % Total | Avg Disp Time | Avg Resp Time | Avg Scene Time | Total Call Time | Avg Call Time |
|-------------|--------------------------------|----------|-----------|-----|-------|---------|---------------|---------------|----------------|-----------------|---------------|
| GEMS        | ABDOMINAL PAIN/PROBLEMS        | 0        | 0         | 6   | 6     | 3%      | 0:02:19       | 0:04:14       | 1:01:16        | 4:35:35         | 0:45:56       |
|             | ALLERGIES/ENVENOMATIONS        | 0        | 0         | 3   | 3     | 2%      | 0:02:20       | 0:10:43       | 0:40:07        | 2:37:11         | 0:52:24       |
|             | AUTOMATIC CRASH NOTIFICATION   | 0        | 0         | 1   | 1     | 1%      | 0:01:22       | 0:05:09       | 0:05:45        | 0:12:16         | 0:12:16       |
|             | BACK PAIN (NON TRAUMATIC)      | 0        | 0         | 3   | 3     | 2%      | 0:03:45       | 0:08:13       | 0:54:41        | 2:46:11         | 0:55:24       |
|             | BREATHING PROBLEMS             | 0        | 0         | 18  | 18    | 10%     | 0:01:57       | 0:07:18       | 1:08:55        | 23:23:41        | 1:17:59       |
|             | CARBON MONOXIDE/INHALATION     | 0        | 0         | 1   | 1     | 1%      | 0:03:40       | 0:06:47       | 0:14:12        | 0:24:39         | 0:24:39       |
|             | CARDIAC OR RESP ARREST         | 0        | 0         | 2   | 2     | 1%      | 0:01:57       | 0:03:02       | 0:43:01        | 1:35:59         | 0:48:00       |
|             | CHEST PAIN (NON-TRAUMATIC)     | 0        | 0         | 11  | 11    | 6%      | 0:02:05       | 0:06:43       | 1:13:05        | 13:42:17        | 1:14:45       |
|             | CONVULSIONS/SEIZURES           | 0        | 0         | 3   | 3     | 2%      | 0:03:05       | 0:06:48       | 0:57:01        | 3:20:45         | 1:06:55       |
|             | DIABETIC PROBLEMS              | 0        | 0         | 3   | 3     | 2%      | 0:02:20       | 0:09:15       | 1:07:18        | 3:54:19         | 1:18:06       |
|             | EMS STANDBY                    | 0        | 0         | 6   | 6     | 3%      | 0:00:27       | 0:05:33       | 0:17:03        | 1:58:44         | 0:19:47       |
|             | FALLS                          | 0        | 0         | 31  | 31    | 18%     | 0:02:31       | 0:07:17       | 0:49:03        | 26:49:18        | 0:51:55       |
|             | HEADACHE                       | 0        | 0         | 1   | 1     | 1%      | 0:02:17       | 0:14:03       | 1:19:08        | 1:35:28         | 1:35:28       |
|             | HEART PROBLEMS                 | 0        | 0         | 5   | 5     | 3%      | 0:03:24       | 0:06:06       | 1:11:15        | 6:43:45         | 1:20:45       |
|             | HEMORRHAGE/LACERATIONS         | 0        | 0         | 4   | 4     | 2%      | 0:02:38       | 0:07:12       | 1:16:34        | 5:45:34         | 1:26:24       |
|             | OVERDOSE/POISONING             | 0        | 0         | 2   | 2     | 1%      | 0:02:41       | 0:03:39       | 1:13:15        | 2:39:09         | 1:19:35       |
|             | PERSONAL INJURY CRASH          | 0        | 0         | 8   | 8     | 5%      | 0:00:19       | 0:08:21       | 0:34:03        | 5:13:48         | 0:39:14       |
|             | PSYCHIATRIC/ABNORMAL BEHAVIOR  | 0        | 0         | 2   | 2     | 1%      | 0:02:15       | 0:09:36       | 0:47:03        | 1:57:46         | 0:58:53       |
|             | SICK PERSON                    | 0        | 1         | 34  | 35    | 20%     | 0:02:14       | 0:07:31       | 0:56:55        | 36:43:38        | 1:02:58       |
|             | STROKE (CVA)                   | 0        | 0         | 9   | 9     | 5%      | 0:02:38       | 0:05:14       | 1:08:01        | 11:15:41        | 1:15:05       |
|             | STRUCTURE FIRE LARGE           | 0        | 0         | 2   | 2     | 1%      | 0:00:15       | 0:18:07       | 1:13:17        | 3:03:03         | 1:31:32       |
|             | TRAFFIC/TRANSPORTATION ACCIDEN | 0        | 0         | 3   | 3     | 2%      | 0:01:07       | 0:11:15       | 1:20:13        | 4:36:39         | 1:32:13       |

| Agency Code | Nature Code                          | Rpt Only | Self Init | CFS        | Total      | % Total     | Avg Disp Time  | Avg Resp Time  | Avg Scene Time | Total Call Time  | Avg Call Time  |
|-------------|--------------------------------------|----------|-----------|------------|------------|-------------|----------------|----------------|----------------|------------------|----------------|
|             | TRAUMATIC INJURIES                   | 0        | 0         | 1          | 1          | 1%          | 0:03:58        | 0:05:36        | 0:58:39        | 1:08:13          | 1:08:13        |
|             | UNCONSCIOUS/FAINTING (NEAR)          | 0        | 0         | 2          | 2          | 1%          | 0:02:01        | 0:04:03        | 1:32:11        | 3:16:31          | 1:38:16        |
|             | UNKNOWN PROBLEM (MAN DOWN)           | 0        | 0         | 12         | 12         | 7%          | 0:02:40        | 0:06:58        | 0:45:30        | 9:22:00          | 0:46:50        |
|             | <b>Subtotals for No Summary Code</b> | <b>0</b> | <b>1</b>  | <b>173</b> | <b>174</b> | <b>100%</b> | <b>0:02:15</b> | <b>0:07:33</b> | <b>0:56:18</b> | <b>178:42:10</b> | <b>1:03:20</b> |
|             | <b>Subtotals for GEMS</b>            | <b>0</b> | <b>1</b>  | <b>173</b> | <b>174</b> | <b>100%</b> | <b>0:02:15</b> | <b>0:07:33</b> | <b>0:56:18</b> | <b>178:42:10</b> | <b>1:03:20</b> |

# EATON COUNTY 911

## Events by Nature Code by Agency

Agency: GLFD, Event date/Time range: 12/01/2025 00:00:00 - 12/31/2025 23:59:59

| Agency Code | Nature Code                          | Rpt Only | Self Init | CFS       | Total     | % Total     | Avg Disp Time  | Avg Resp Time  | Avg Scene Time | Total Call Time | Avg Call Time  |
|-------------|--------------------------------------|----------|-----------|-----------|-----------|-------------|----------------|----------------|----------------|-----------------|----------------|
| GLFD        | AUTOMATIC CRASH NOTIFICATION         | 0        | 0         | 1         | 1         | 1%          | 0:00:22        | 0:05:46        | 0:05:25        | 0:11:33         | 0:11:33        |
|             | CARDIAC OR RESP ARREST               | 0        | 0         | 2         | 2         | 2%          | 0:00:17        | 0:04:35        | 0:39:50        | 1:29:23         | 0:44:42        |
|             | COMMERCIAL FIRE ALARM                | 0        | 0         | 3         | 3         | 3%          | 0:01:21        | 0:04:01        | 0:13:59        | 0:53:14         | 0:17:45        |
|             | COMMERCIAL STRUCTURE FIRE            | 0        | 0         | 4         | 4         | 5%          | 0:00:01        | 0:00:00        | 0:00:00        | 0:42:32         | 0:10:38        |
|             | MEDICAL ASSIST                       | 0        | 0         | 48        | 48        | 55%         | 0:00:12        | 0:04:38        | 0:16:46        | 16:04:55        | 0:20:06        |
|             | MISCELLANEOUS FIRE RUN               | 1        | 0         | 3         | 4         | 5%          | 0:00:07        | 0:11:05        | 0:30:03        | 1:30:08         | 0:30:03        |
|             | ODOR INVESTIGATION                   | 0        | 0         | 7         | 7         | 8%          | 0:01:33        | 0:07:13        | 0:13:37        | 2:36:45         | 0:22:24        |
|             | PERSONAL INJURY CRASH                | 0        | 0         | 7         | 7         | 8%          | 0:00:19        | 0:06:25        | 0:20:21        | 2:48:34         | 0:24:05        |
|             | RESIDENTIAL FIRE ALARM               | 0        | 0         | 2         | 2         | 2%          | 0:01:10        | 0:06:57        | 0:11:55        | 0:40:03         | 0:20:02        |
|             | STRUCTURE FIRE LARGE                 | 0        | 0         | 5         | 5         | 6%          | 0:00:26        | 0:11:47        | 1:10:51        | 7:22:17         | 1:28:27        |
|             | VEHICLE FIRE                         | 0        | 0         | 1         | 1         | 1%          | 0:01:24        | 0:03:34        | 0:22:31        | 0:27:29         | 0:27:29        |
|             | WIRES DOWN                           | 1        | 1         | 2         | 4         | 5%          | 0:01:58        | 0:06:31        | 0:02:59        | 0:32:27         | 0:10:49        |
|             | <b>Subtotals for No Summary Code</b> | <b>2</b> | <b>1</b>  | <b>85</b> | <b>88</b> | <b>100%</b> | <b>0:00:46</b> | <b>0:06:36</b> | <b>0:22:34</b> | <b>35:19:20</b> | <b>0:27:20</b> |
|             | <b>Subtotals for GLFD</b>            | <b>2</b> | <b>1</b>  | <b>85</b> | <b>88</b> | <b>100%</b> | <b>0:00:46</b> | <b>0:06:36</b> | <b>0:22:34</b> | <b>35:19:20</b> | <b>0:27:20</b> |



|                          | City   | Oneida | M/A    | Total Calls |
|--------------------------|--------|--------|--------|-------------|
| YTD Total Fire Responses | 674    | 187    | 167    | 1028        |
|                          | 65.56% | 18.19% | 16.25% |             |

| NFIRs num                        | Call Type                               | City      | Oneida    | M/A       |           |
|----------------------------------|---|-----------|-----------|-----------|-----------|
| 111                              | Building Fire                           | 1         | 1         | 3         |           |
| 131                              | Pass. Vehicle Fire                      | 1         |           |           |           |
| 142                              | Brush/Grass Fire                        |           |           |           |           |
| 161                              | Outside Storage Fire                    |           |           |           |           |
| 200                              | Overpressure/Rupture                    |           |           |           |           |
| 300                              | Rescue, EMS incident                    |           |           |           |           |
| 311                              | Medical Assist                          | 31        | 6         |           |           |
| 321                              | Medial First Responder Call             | 11        | 4         | 4         |           |
| 322                              | Motor Vehicle Crash w/injuries          |           |           |           |           |
| 3612                             | River Rescue                            |           |           |           |           |
| 324                              | Motor vehicle crash w/o injury          |           |           |           |           |
| 350                              | Extrication rescue                      |           | 1         | 1         |           |
| 400                              | Hazardous Condition                     |           |           |           |           |
| 412                              | Gas Leak (Nat or LP)                    | 1         |           |           |           |
| 421                              | Chemical Hazard                         |           | 1         |           |           |
| 424                              | Carbon Monoxide Incident                | 1         |           |           |           |
| 445                              | Arcing, shorted Electrical Equipment    |           |           |           |           |
| 444                              | Power line Down                         | 1         |           |           |           |
| 461                              | Building or Weakened Structure          |           |           |           |           |
| 480                              | Attempted Burning                       |           |           |           |           |
| 510                              | Person in Distress                      |           |           |           |           |
| 550                              | Public Service                          | 2         |           |           |           |
| 531                              | Smoke or Odor                           |           |           |           |           |
| 561                              | Unauthorized Burning                    |           |           |           |           |
| 571                              | Standby or moveup                       |           |           |           |           |
| 600                              | Good Intemt                             | 7         |           | 1         |           |
| 6001                             | Wires Down Not Electrical               |           |           |           |           |
| 611                              | Disp Cancelled Enroute                  | 4         |           | 5         |           |
| 631                              | Authorized burning                      |           |           |           |           |
| 652                              | Steam, fog or dust thought to be smoke  |           |           |           |           |
| 671                              | Hazmat investigation                    | 1         |           |           |           |
| 700                              | False Alarm                             | 1         |           |           |           |
| 731                              | Sprinkler activation due to malfunction |           |           |           |           |
| 736                              | CO det act due to malfunction           | 1         |           |           |           |
| 740                              | Uninten trans of alarm                  | 3         |           |           |           |
| 745                              | Alarm Active No Fire                    |           |           |           |           |
| 746                              | CO Alarm No CO                          |           |           |           |           |
| <b>Dec. Total Fire Responses</b> |   | <b>66</b> | <b>13</b> | <b>14</b> | <b>93</b> |

FINANCIAL ANALYSIS  
 FINANCIAL TRANSACTIONS

| CODE | FINANCIAL CATEGORY      | RECEIPTS        |                      |         | CHARGES         |                      |         |
|------|-------------------------|-----------------|----------------------|---------|-----------------|----------------------|---------|
|      |                         | THIS MONTH (\$) | MONTHLY AVERAGE (\$) | % MONTH | THIS MONTH (\$) | MONTHLY AVERAGE (\$) | % MONTH |
| A    | PRIVATE PAY             | 0.00            | 0.00                 | 0%      | 962.00          | 160.33               | 0%      |
| 01   | MEDICAID-MICHIGAN       | 1,521.79        | 1,110.17             | 1%      | 0.00            | 2,007.80             | 2%      |
| 02   | MEDICARE-MICHIGAN       | 7,851.48        | 9,706.10             | 13%     | 14,237.20       | 14,699.33            | 11%     |
| 03   | FEP                     | 0.00            | 0.00                 | 0%      | 0.00            | 0.00                 | 0%      |
| 04   | BCBSM                   | 9,501.73        | 9,526.67             | 13%     | 10,761.00       | 12,491.93            | 10%     |
| 05   | WORKERS' COMP           | 0.00            | 0.00                 | 0%      | 0.00            | 0.00                 | 0%      |
| 07   | MCARE                   | 3,402.37        | 2,314.51             | 3%      | 5,727.40        | 4,250.30             | 3%      |
| 11   | BCN                     | 5,922.24        | 7,010.99             | 9%      | 9,400.40        | 11,201.20            | 9%      |
| 12   | CHAMPUS/TRICARE         | 0.00            | 0.00                 | 0%      | 0.00            | 698.33               | 1%      |
| 13   | CIGNA/CONNECTICUT GENER | 0.00            | 172.75               | 0%      | 0.00            | 0.00                 | 0%      |
| 14   | AETNA LIFE & CASUALTY   | 517.74          | 341.75               | 0%      | 0.00            | 173.67               | 0%      |
| 34   | RR MEDICARE-TRAVELERS   | 0.00            | 0.00                 | 0%      | 0.00            | 0.00                 | 0%      |
| 59   | UNITED HEALTH CARE      | 1,877.92        | 1,191.15             | 2%      | 1,803.20        | 1,617.00             | 1%      |
| 99   | GOLDEN RULE INSURANCE C | 0.00            | 107.47               | 0%      | 0.00            | 0.00                 | 0%      |
| 09A  | PHP                     | 3,541.67        | 1,916.02             | 3%      | 2,158.00        | 2,804.93             | 2%      |
| MCD  | MEDICAL ASSISTANCE      | 1,425.82        | 1,023.46             | 1%      | 4,129.20        | 2,606.53             | 2%      |
| 3936 | VETERANS ADMINISTRATION | 0.00            | 1,599.60             | 2%      | 0.00            | 1,614.07             | 1%      |
| 5001 | ALLIED BENEFITS         | 218.17          | 213.56               | 0%      | 0.00            | 394.50               | 0%      |
| 5013 | PRIORITY HEALTH         | 0.00            | 641.44               | 1%      | 1,358.00        | 997.67               | 1%      |
| 5092 | PRAIRIE STATES          | 0.00            | 0.00                 | 0%      | 0.00            | 0.00                 | 0%      |
| 5166 | MCLAREN HEALTH PLAN     | 0.00            | 352.67               | 0%      | 0.00            | 352.67               | 0%      |
| 5855 | UMR                     | 0.00            | 0.00                 | 0%      | 0.00            | 187.00               | 0%      |
| A002 | MERITAIN HEALTH         | 0.00            | 0.00                 | 0%      | 0.00            | 0.00                 | 0%      |
| A003 | ALLSTATE                | 946.00          | 157.67               | 0%      | 0.00            | 157.67               | 0%      |
| A004 | AUTO OWNERS             | 0.00            | 899.35               | 1%      | 1,122.34        | 724.53               | 1%      |
| A005 | CITIZENS                | 0.00            | 363.33               | 0%      | 0.00            | 176.33               | 0%      |
| A008 | FARM BUREAU             | 219.60          | 483.88               | 1%      | 0.00            | 179.00               | 0%      |
| A015 | STATE FARM INSURANCE    | 1,152.70        | 404.23               | 1%      | 1,026.00        | 1,082.00             | 1%      |
| A018 | FARMERS INSURANCE GROUP | 0.00            | 0.00                 | 0%      | 0.00            | 0.00                 | 0%      |
| A037 | LIBERTY MUTUAL          | 0.00            | 0.00                 | 0%      | 0.00            | 0.00                 | 0%      |
| A073 | PROGRESSIVE AUTO        | 978.00          | 391.00               | 1%      | 1,138.00        | 761.17               | 1%      |
| A077 | USAA                    | 0.00            | 163.00               | 0%      | 0.00            | 368.67               | 0%      |
| A080 | FREMONT MUTUAL INS      | 0.00            | 179.27               | 0%      | 0.00            | 0.00                 | 0%      |
| A091 | FRANKENMUTH INS         | 0.00            | 0.00                 | 0%      | 0.00            | 0.00                 | 0%      |
| A131 | PIONEER STATE MUTUAL    | 0.00            | 0.00                 | 0%      | 0.00            | 0.00                 | 0%      |
| COMM | ESURANCE INSURANCE      | 0.00            | 0.00                 | 0%      | 0.00            | 0.00                 | 0%      |
| M001 | COMMERCIAL INSURANCE    | 552.89          | 595.97               | 1%      | 0.00            | 0.00                 | 0%      |
| M004 | MCLAREN HEALTH PLAN     | 8,450.45        | 6,759.83             | 9%      | 25,898.90       | 16,103.02            | 12%     |
| M005 | MOLINA HEALTH CARE OF M | 0.00            | 79.04                | 0%      | 0.00            | 175.80               | 0%      |
| M015 | PRIORITY HEALTH         | 0.00            | 60.91                | 0%      | 0.00            | 164.53               | 0%      |
| M016 | GREAT LAKES HEALTH PLAN | 0.00            | 1,293.88             | 2%      | 0.00            | 1,831.63             | 1%      |
| P001 | MERIDIAN HEALTH PLAN    | 0.00            | 75.14                | 0%      | 0.00            | 343.53               | 0%      |
| P004 | HUMANA GOLD PLUS        | 3,749.31        | 5,983.58             | 8%      | 10,716.70       | 11,117.92            | 9%      |
| P013 | MEDICARE PLUS BCBSM     | 18,827.44       | 15,075.30            | 20%     | 35,281.00       | 27,241.87            | 21%     |
| P017 | AETNA ADVANTAGE         | 410.68          | 870.43               | 1%      | 1,014.40        | 1,964.57             | 2%      |
| P041 | AETNA WELLCARE          | 0.00            | 90.40                | 0%      | 0.00            | 159.27               | 0%      |
| F101 | PRIORITY HEALTH ADVANTA | 3,159.26        | 2,473.89             | 3%      | 7,807.20        | 4,539.83             | 4%      |
| F101 | HAP SENIOR PLUS         | 319.41          | 55.80                | 0%      | 1,062.80        | 177.13               | 0%      |



DATE PRINTED : 12/31/25  
 CLOSING DATE : 12/31/25

MANAGEMENT LETTER DECEMBER 2025 BY TOTAL PRACTICE  
 FOR GRAND LEDGE AREA AMBULANCE SRV  
 TOTAL PRACTICE

| CODE | ADJUSTMENT CODE                | THIS MONTH (\$) | MONTHLY AVERAGE (\$) | % AVG MONTH | YEAR TO DATE (\$) |
|------|--------------------------------|-----------------|----------------------|-------------|-------------------|
| C2   | COURTESY DISCOUNT PER CLIENT   | 0.00            | -146.90              | 0%          | -1,873.92         |
| C3   | BCBSM CONTRACTUAL WRITEOFF     | -1,962.47       | -2,026.50            | 3%          | -21,975.08        |
| C4   | MEDICARE CONTRACTUAL WRITEOFF  | -6,334.15       | -7,174.36            | 11%         | -97,558.34        |
| C7   | SMALL BALANCE CREDIT           | -10.11          | -9.36                | 0%          | -99.98            |
| C9   | MEDICAID CONTRACTUAL WRITEOFF  | -7,588.26       | -4,985.88            | 8%          | -49,257.32        |
| CD   | PHP CONTRACTUAL WRITEOFF       | -2,322.30       | -482.45              | 1%          | -2,894.68         |
| ce   | WORKERS COMP CONTRACT WRITEOFF | 0.00            | -102.68              | 0%          | -1,270.04         |
| Cf   | TRICARE CONTRACTUAL WRITEOFF   | 0.00            | 0.00                 | 0%          | -456.61           |
| Cg   | AUTO INSURANCE WRITEOFF        | -1.30           | -5.19                | 0%          | -643.79           |
| Ck   | MISC CONTRACTUAL WRITEOFF      | -3,095.77       | -2,308.24            | 4%          | -23,676.31        |
| CK   | COLLECTION BAD DEBT SYS USED   | -8,650.43       | -9,058.22            | 14%         | -76,987.08        |
| CL   | BCN-HC CONTRACTUAL WRITEOFF    | -1,488.34       | -1,870.04            | 3%          | -22,783.55        |
| C1   | MEDICAID HMO CONTRACT WRITEOFF | -11,378.44      | -10,559.77           | 17%         | -108,617.89       |
| CZ   | SMALL BALANCE CREDIT SYS/USE   | 0.00            | 0.00                 | 0%          | -0.50             |
| CIW  | CIGNA CONTRACTUAL WRITEOFF     | 0.00            | -15.53               | 0%          | -93.15            |
| CMP  | MCR PLUS CONTRACTUAL WRITEOFF  | -21,189.12      | -22,234.35           | 35%         | -258,860.89       |
| CUH  | UHC CONTRACTUAL WRITEOFF       | 0.00            | -10.00               | 0%          | -99.53            |
| C223 | GOVT MANDATED ADJ (CREDIT)     | -695.91         | -1,033.74            | 2%          | -10,298.65        |
| DECE | DECEASED                       | -858.47         | -696.68              | 1%          | -5,173.33         |
|      | CREDIT TOTALS                  | -65,575.07      | -62,719.89           | 100%        | -682,620.64       |
| D1   | SMALL BALANCE DEBIT            | 9.21            | 4.12                 | 0%          | 47.38             |
| D4   | REFUND                         | 315.00          | 87.92                | 4%          | 8,483.05          |
| D5   | WRITE-OFF CORRECTION           | 1,604.96        | 1,555.87             | 68%         | 13,674.95         |
| D8   | COLLECTION RECOVERY            | 3,548.54        | 627.12               | 28%         | 10,705.99         |
| DZ   | SMALL BALANCE DEBIT SYS USED   | 0.00            | 0.00                 | 0%          | 0.10              |
| DIP  | CARRIER INTEREST PAYMENT       | 0.00            | 1.38                 | 0%          | 14.73             |
| D223 | GOVT MANDATED ADJ (DEBIT)      | 11.40           | 3.04                 | 0%          | 33.97             |
|      | DEBIT TOTALS                   | 5,489.11        | 2,279.45             | 100%        | 32,960.17         |
|      | TOTALS                         | -60,085.96      | -60,440.44           |             | -649,660.47       |

MANAGEMENT LETTER DECEMBER 2025 BY TOTAL PRACTICE  
 FOR GRAND LEDGE AREA AMBULANCE SRV  
 TOTAL PRACTICE

| CODE   | FINANCIAL CATEGORY          | AMOUNT (\$) | % OF TOTAL | DAYS IN A/R |
|--------|-----------------------------|-------------|------------|-------------|
| A      | PRIVATE PAY                 | 962.00      | 1.0%       |             |
| 01     | MEDICAID-MICHIGAN           | 1,585.50    | 1.0%       |             |
| 02     | MEDICARE-MICHIGAN           | 8,590.00    | 7.0%       | 18          |
| 03     | FEP                         | 126.84      | 0.0%       |             |
| 04     | BCBSM                       | -12,570.02  | -11.0%     |             |
| 07     | MCARE                       | 2,383.80    | 2.0%       |             |
| 11     | BCN                         | 4,240.40    | 4.0%       | 11          |
| 12     | CHAMPUS/TRICARE             | 4,190.00    | 4.0%       | 180         |
| 45     | AARP                        | 360.02      | 0.0%       |             |
| 59     | UNITED HEALTH CARE          | 2,048.88    | 2.0%       |             |
| 09A    | PHP                         | 1,150.00    | 1.0%       |             |
| MCD    | MEDICAL ASSISTANCE          | 1,125.20    | 1.0%       |             |
| 1581   | CHAMPVA                     | 113.06      | 0.0%       |             |
| 3002   | VETERANS ADMINISTRATION     | 1,075.60    | 1.0%       |             |
| 5001   | PRIORITY HEALTH             | 1,358.00    | 1.0%       |             |
| A003   | AUTO OWNERS                 | 2,244.00    | 2.0%       |             |
| A005   | FARM BUREAU                 | 740.14      | 1.0%       |             |
| A008   | STATE FARM INSURANCE        | 2,898.71    | 2.0%       |             |
| A037   | PROGRESSIVE AUTO            | 2,276.00    | 2.0%       |             |
| A080   | FRANKENMUTH INS             | 1,154.00    | 1.0%       |             |
| COLL   | COLLECTION                  | 1,295.00    | 1.0%       |             |
| COMM   | COMMERCIAL INSURANCE        | 2,453.60    | 2.0%       |             |
| HOLD   | HOLD STATUS                 | 6,363.46    | 5.0%       |             |
| LETT   | COLLECTION LETTERS          | 15,241.36   | 13.0%      |             |
| M001   | MCLAREN HEALTH PLAN         | 13,079.89   | 11.0%      | 24          |
| M015   | GREAT LAKES HEALTH PLAN INC | 1,133.20    | 1.0%       |             |
| P001   | HUMANA GOLD PLUS            | 7,173.62    | 6.0%       | 19          |
| P004   | MEDICARE PLUS BCBSM         | 9,489.80    | 8.0%       | 10          |
| P013   | AETNA ADVANTAGE             | 1,014.40    | 1.0%       |             |
| P041   | PRIORITY HEALTH ADVANTAGE   | 2,125.20    | 2.0%       |             |
| SELF   | SELF PAY                    | 29,733.18   | 26.0%      | 315         |
| W108   | HASTINGS MUTUAL             | 1,249.00    | 1.0%       |             |
| TOTALS |                             | 116,403.84  | 100.0%     | 27          |

\*CALCULATED USING AVG TOTAL  
 \*CALCULATED USING AVG TOTAL

LAPSE TIME FROM SERVICE DATE TO BILLING IS 15 DAYS. LAST MONTH 12 DAYS.

MANAGEMENT LETTER DECEMBER 2025 BY TOTAL PRACTICE  
 FOR GRAND LEDGE AREA AMBULANCE SRV  
 TOTAL PRACTICE

INCOME ANALYSIS  
 MONTHLY COMPARISON

| MONTH                                 | ENCOUNTERS | CHARGES (\$) | RECEIPTS (\$) | ADJUSTMENTS (\$) | ENDING A/R (\$) | DAYS<br>IN A/R | MOVED TO<br>CO STATUS |
|---------------------------------------|------------|--------------|---------------|------------------|-----------------|----------------|-----------------------|
| JANUARY                               | 143        | 143,285.89   | -67,098.79    | -48,079.78       | 138,337.23      | 34             | 3,613.82              |
| FEBRUARY                              | 109        | 109,695.50   | -57,562.04    | -48,507.76       | 141,962.93      | 35             | 6,899.04              |
| MARCH                                 | 119        | 119,956.73   | -65,013.04    | -48,737.50       | 148,169.12      | 37             | 8,568.89              |
| APRIL                                 | 107        | 107,531.10   | -67,801.03    | -52,805.53       | 135,093.66      | 34             | 7,365.70              |
| MAY                                   | 160        | 163,536.66   | -62,922.08    | -49,657.22       | 186,051.02      | 44             | 8,362.55              |
| JUNE                                  | 111        | 112,045.86   | -84,207.82    | -56,211.35       | 157,677.71      | 38             | 2,451.60              |
| JULY                                  | 135        | 136,762.10   | -79,918.48    | -45,785.70       | 168,735.63      | 41             | 4,461.14              |
| AUGUST                                | 112        | 113,709.03   | -83,718.45    | -51,103.62       | 147,622.59      | 35             | 9,689.41              |
| SEPTEMBER                             | 130        | 130,816.47   | -84,446.15    | -51,788.64       | 142,204.27      | 33             | 6,476.70              |
| OCTOBER                               | 140        | 143,678.94   | -83,129.19    | -54,183.64       | 148,570.38      | 33             | 3,552.25              |
| NOVEMBER                              | 107        | 108,204.93   | -61,945.52    | -47,472.32       | 147,357.47      | 36             | 12,285.86             |
| DECEMBER                              | 118        | 117,518.72   | -79,094.38    | -61,745.84       | 124,035.97      | 30             | 10,298.70             |
| JANUARY                               | 107        | 107,023.30   | -59,242.09    | -42,673.23       | 129,143.95      | 32             | 6,984.87              |
| FEBRUARY                              | 135        | 135,478.87   | -77,195.44    | -51,679.21       | 135,748.17      | 33             | 5,777.43              |
| MARCH                                 | 124        | 125,701.22   | -83,489.24    | -52,687.06       | 125,273.09      | 31             | 2,744.35              |
| APRIL                                 | 137        | 137,553.28   | -92,886.77    | -40,385.97       | 129,553.63      | 32             | 1,980.76              |
| MAY                                   | 144        | 151,681.96   | -88,044.23    | -52,958.85       | 140,232.51      | 33             | 2,937.50              |
| JUNE                                  | 117        | 129,642.20   | -69,462.74    | -46,633.52       | 153,778.45      | 35             | 1,725.42              |
| JULY                                  | 123        | 135,972.80   | -75,051.58    | -63,739.13       | 150,960.54      | 33             | 12,827.29             |
| AUGUST                                | 131        | 147,013.60   | -79,295.26    | -60,586.26       | 158,092.62      | 34             | 7,099.29              |
| SEPTEMBER                             | 108        | 118,339.00   | -59,105.45    | -47,576.62       | 169,749.55      | 37             | 6,650.74              |
| OCTOBER                               | 124        | 134,186.60   | -93,007.23    | -72,146.83       | 138,782.09      | 31             | 8,516.97              |
| NOVEMBER                              | 101        | 102,358.00   | -64,633.50    | -58,507.83       | 117,998.76      | 28             | 8,582.27              |
| DECEMBER                              | 124        | 135,623.00   | -77,131.96    | -60,085.96       | 116,403.84      | 27             | 7,856.85              |
| CURRENT MONTH COMPARED TO THE AVERAGE |            |              |               |                  |                 |                |                       |
| DECEMBER                              | 124        | 135,623.00   | -77,131.96    | -60,085.96       | 116,403.84      |                | 7,856.85              |
| AVERAGE                               | 119        | 128,915.50   | -74,704.16    | -60,440.44       | 141,997.90      |                | 8,588.90              |
|                                       | Up         | 4%           | Up            | Down             | Down            |                | Down 9%               |
|                                       |            |              | 3%            | 1%               | 18%             |                |                       |

ENCOUNTER STATISTICS  
 MONTHLY COMPARISON

| MONTH     | ENCOUNTERS | AVG ENCTR | CURRENT<br>MTH CHG/ENCTR | AVG MTH CHG/<br>AVG MTH ENCTR | AVG MTH REC/<br>AVG MTH ENCTR | AVG MTH ADJ/<br>AVG MTH ENCTR |
|-----------|------------|-----------|--------------------------|-------------------------------|-------------------------------|-------------------------------|
| JANUARY   | 143        | 120       | 1,002.00                 | 1,003.28                      | -574.85                       | -425.34                       |
| FEBRUARY  | 109        | 120       | 1,006.38                 | 1,001.82                      | -550.49                       | -410.53                       |
| MARCH     | 119        | 120       | 1,008.04                 | 1,004.12                      | -549.99                       | -408.74                       |
| APRIL     | 107        | 117       | 1,004.96                 | 1,005.86                      | -561.27                       | -423.45                       |
| MAY       | 160        | 125       | 1,022.10                 | 1,009.47                      | -499.17                       | -381.12                       |
| JUNE      | 111        | 125       | 1,009.42                 | 1,008.07                      | -539.47                       | -405.33                       |
| JULY      | 135        | 124       | 1,013.05                 | 1,007.43                      | -561.05                       | -405.52                       |
| AUGUST    | 112        | 124       | 1,015.26                 | 1,012.82                      | -596.21                       | -409.01                       |
| SEPTEMBER | 130        | 126       | 1,006.28                 | 1,011.11                      | -612.45                       | -406.55                       |
| OCTOBER   | 140        | 131       | 1,026.28                 | 1,018.51                      | -608.58                       | -392.79                       |
| NOVEMBER  | 107        | 123       | 1,011.26                 | 1,009.78                      | -646.84                       | -415.37                       |
| DECEMBER  | 118        | 124       | 995.92                   | 1,008.99                      | -634.75                       | -419.46                       |
| JANUARY   | 107        | 119       | 1,000.22                 | 1,009.74                      | -632.46                       | -432.73                       |
| FEBRUARY  | 135        | 123       | 1,003.55                 | 1,006.40                      | -603.05                       | -419.43                       |
| MARCH     | 124        | 122       | 1,013.72                 | 1,007.66                      | -606.69                       | -424.10                       |
| APRIL     | 137        | 121       | 1,004.04                 | 1,007.55                      | -625.14                       | -408.60                       |
| MAY       | 144        | 128       | 1,053.35                 | 1,009.06                      | -624.94                       | -393.40                       |
| JUNE      | 117        | 127       | 1,108.05                 | 1,032.91                      | -617.22                       | -376.66                       |
| JULY      | 123        | 130       | 1,105.47                 | 1,046.19                      | -623.24                       | -394.98                       |
| AUGUST    | 131        | 129       | 1,122.24                 | 1,069.21                      | -630.79                       | -409.55                       |
| SEPTEMBER | 108        | 127       | 1,095.73                 | 1,076.38                      | -608.72                       | -409.29                       |
| OCTOBER   | 124        | 125       | 1,082.15                 | 1,089.11                      | -618.62                       | -458.19                       |
| NOVEMBER  | 101        | 117       | 1,013.45                 | 1,093.32                      | -627.57                       | -497.42                       |
| DECEMBER  | 124        | 119       | 1,093.73                 | 1,083.32                      | -627.77                       | -507.90                       |

DATE PRINTED : 12/31/25  
 CLOSING DATE : 12/31/25

MANAGEMENT LETTER DECEMBER 2025 BY TOTAL PRACTICE  
 FOR GRAND LEDGE AREA AMBULANCE SRV  
 TOTAL PRACTICE

| STATISTICAL INFORMATION          |       |                    |            |                   |
|----------------------------------|-------|--------------------|------------|-------------------|
| ITEM                             | COUNT | MONTH TO DATE (\$) | % OF TOTAL | YEAR TO DATE (\$) |
| PATIENT ENCOUNTERS               | 124   | 135,623.00         |            | 1,560,573.83      |
| NEW INSURANCE CLAIMS SENT        | 155   | 156,046.29         |            | 1,770,072.76      |
| INSURANCE FOLLOW-UP SENT         | 0     | 0.00               |            | 0.00              |
| HARDCOPY INSURANCE CLAIMS SENT   | 13    | 12,958.42          | 8.30%      | 89,911.27         |
| CLAIMS SUBMITTED ELECTRONICALLY  | 142   | 143,087.87         | 91.70%     | 1,680,161.49      |
| PRIVATE STATEMENTS SENT          | 93    | 0.00               |            | 0.00              |
| DUNNING LETTERS SENT             | 33    | 14,498.54          |            | 132,109.78        |
| MOVED TO CO STATUS               | 22    | 7,856.85           |            | 73,683.74         |
| INTEREST/LATE FEE                | 0     | 0.00               |            | 0.00              |
| OVERPAYMENT LETTERS              | 0     | 0.00               |            | 0.00              |
| REFUND SHEETS                    | 1     | 315.00             |            | 8,483.05          |
| DEMAND PRINTED INSURANCE BILLS   | 0     | 0.00               |            | 0.00              |
| DEMAND PRINTED STATEMENTS        | 0     | 0.00               |            | 0.00              |
| OUTSOURCED STATEMENTS SENT       | 93    | 0.00               |            | 0.00              |
| FAST FORWARD UPDATES             | 0     |                    |            |                   |
| RECEIPTS POSTED ELECTRONICALLY   | 135   | 59,127.51          | 76.66%     | 677,220.68        |
| CREDIT CARD PAYMENTS             | 0     | 0.00               |            | 0.00              |
| EOB TO 835 POSTING               | 0     | 0.00               |            | 0.00              |
| SELF PAY REMITTANCE              | 0     | 0.00               |            | 0.00              |
| INSURANCE REMITTANCE             | 135   | 59,127.51          |            | 677,220.68        |
| ROSTER INVOICES GENERATED        | 0     |                    |            |                   |
| TOTAL OUTSOURCED INVOICES        | 0     |                    |            |                   |
| TOTAL OUTSOURCED PAGES           | 0     |                    |            |                   |
| TOTAL FAXED INVOICES             | 0     |                    |            |                   |
| TOTAL FAXED PAGES                | 0     |                    |            |                   |
| TOTAL EMAILED INVOICES           | 0     |                    |            |                   |
| DEMAND ROSTER INVOICES GENERATED | 0     |                    |            |                   |
| TOTAL OUTSOURCED INVOICES        | 0     |                    |            |                   |
| TOTAL OUTSOURCED PAGES           | 0     |                    |            |                   |
| TOTAL FAXED INVOICES             | 0     |                    |            |                   |
| TOTAL FAXED PAGES                | 0     |                    |            |                   |
| PATIENTS ON FILE                 | 2,738 |                    |            |                   |
| LAST TICKET NUMBER USED          | 12567 |                    |            |                   |

\*\*\*\* - Calculated number too large or too small to display

# ◆ RIVERSIDE ◆ ◆ ACCOUNTING, INC. ◆

321 N. BRIDGE STREET • GRAND LEDGE, MI 48837 • VOICE (517) 364-1040 • FAX (517) 627-6863

## **GRAND LEDGE AREA EMERGENCY SERVICES AUTHORITY**

### **Board of Directors**

500 N Clinton Street  
Grand Ledge, MI 48837

### **ACCOUNTANT'S COMPILATION REPORT**

We are providing the accompanying Balance Sheet for the **GRAND LEDGE AREA EMERGENCY SERVICES AUTHORITY** as of December 31, 2025, as well as the related Statement of Revenues and Expenditures for the period then ended.

These statements are limited to presenting, in the form of financial statements, information that is the representation of management. We are not qualified to audit or review the accompanying financial statements and accordingly do not express any opinion or any other form of assurance on them.

Management has elected to omit substantially all the disclosures, and the statement of cash flows required by U.S. generally accepted accounting principles. If the omitted disclosures and statement of cash flows were included in the financial statements, they might influence the user's conclusions about the Organization's financial position, and the results of operations, and cash flows. Accordingly, these financial statements are not designed for those who are not informed about such matters.



Riverside Accounting, Inc.  
January 16, 2026

Grand Ledge Area Emergency Services  
Balance Sheet  
December 31, 2025

|                                | This Year       | Last Year       |
|--------------------------------|-----------------|-----------------|
| <b>ASSETS</b>                  |                 |                 |
| Current Assets                 |                 |                 |
| Dart Checking                  | \$ 35,303.63    | \$ 566,624.81   |
| Dart Future Reserved           | 625,593.28      | 452,603.24      |
| Dart Muni MM                   | 889,323.91      | 1,001,795.11    |
| Prepaid Expenses               | 69,418.98       | 19,371.44       |
| Accounts Receivable            | 54,767.02       | 125,802.92      |
| Allowance for Doubtful Account | (31,740.00)     | (31,740.00)     |
| Accounts Receivable - Other    | 150.00          | 150.00          |
|                                | <hr/>           | <hr/>           |
| Total Current Assets           | 1,642,816.82    | 2,134,607.52    |
| Property and Equipment         |                 |                 |
|                                | <hr/>           | <hr/>           |
| Total Property and Equipment   | 0.00            | 0.00            |
| Other Assets                   |                 |                 |
|                                | <hr/>           | <hr/>           |
| Total Other Assets             | 0.00            | 0.00            |
|                                | <hr/>           | <hr/>           |
| Total Assets                   | \$ 1,642,816.82 | \$ 2,134,607.52 |
|                                | <hr/> <hr/>     | <hr/> <hr/>     |
| <b>LIABILITIES AND CAPITAL</b> |                 |                 |
| Current Liabilities            |                 |                 |
| Accounts Payable               | \$ 93,701.27    | \$ 36,301.04    |
| Accrued Sick & Vacation        | 0.00            | 0.33            |
| Deferred Revenue               | 61,259.99       | 564,624.72      |
|                                | <hr/>           | <hr/>           |
| Total Current Liabilities      | 154,961.26      | 600,926.09      |
| Long-Term Liabilities          |                 |                 |
|                                | <hr/>           | <hr/>           |
| Total Long-Term Liabilities    | 0.00            | 0.00            |
|                                | <hr/>           | <hr/>           |
| Total Liabilities              | 154,961.26      | 600,926.09      |
| Capital                        |                 |                 |
| Reserved for Future Equipment  | 365,799.84      | 365,799.84      |
| Fund Balance                   | 1,329,432.41    | 987,892.37      |
| Net Income                     | (207,376.69)    | 179,989.22      |
|                                | <hr/>           | <hr/>           |
| Total Capital                  | 1,487,855.56    | 1,533,681.43    |
|                                | <hr/>           | <hr/>           |
| Total Liabilities & Capital    | \$ 1,642,816.82 | \$ 2,134,607.52 |
|                                | <hr/> <hr/>     | <hr/> <hr/>     |

See Accountant's Report

Grand Ledge Area Emergency Services  
Income Statement  
Compared with Budget  
For the Six Months Ending December 31, 2025

| ID                   | Description                | Current<br>Actual | Current<br>Budget | YTD<br>Actual       | YTD<br>Budget       |
|----------------------|----------------------------|-------------------|-------------------|---------------------|---------------------|
| <b>Revenues</b>      |                            |                   |                   |                     |                     |
| 101 402 001          | GL Millage                 | \$ 67,499.17      | \$ 79,322.60      | \$ 408,412.12       | \$ 475,935.62       |
| 101 402 002          | Oneida Millage             | 43,466.76         | 52,701.03         | 260,800.56          | 316,206.20          |
| 101 402 003          | City DDA Capture           | (21,502.50)       | (21,502.50)       | (129,015.00)        | (129,015.00)        |
| 101 402 004          | GL Millage 2.0             | 53,296.40         | 53,296.48         | 319,778.40          | 319,778.87          |
| 101 402 005          | Oneida Millage 2.0         | 35,409.57         | 35,409.57         | 212,457.42          | 212,457.46          |
| 101 450 001          | Training Income            | 0.00              | 0.00              | 100.00              | 0.00                |
| 101 580 001          | EMS Service Agreement Fee  | 0.00              | 0.00              | 4,000.00            | 4,000.00            |
| 101 627 001          | Service Runs Billings      | 0.00              | 68,750.00         | 642,001.02          | 412,500.00          |
| 101 627 002          | Service Runs Contract W/O  | 0.00              | 0.00              | (256,705.49)        | 0.00                |
| 101 627 003          | Service Runs Bad Debt W/O  | 0.00              | 0.00              | (42,986.09)         | 0.00                |
| 101 664 001          | Interest/Dividend Income   | 1,670.46          | 1,750.00          | 16,102.12           | 10,500.00           |
| 101 671 001          | Miscellaneous Revenue      | 0.00              | 0.00              | 335.00              | 0.00                |
|                      | <b>Total Revenues</b>      | <u>179,839.86</u> | <u>269,727.18</u> | <u>1,435,280.06</u> | <u>1,622,363.15</u> |
| <b>Cost of Sales</b> |                            |                   |                   |                     |                     |
|                      | <b>Total Cost of Sales</b> | <u>0.00</u>       | <u>0.00</u>       | <u>0.00</u>         | <u>0.00</u>         |
|                      | <b>Gross Profit</b>        | <u>179,839.86</u> | <u>269,727.18</u> | <u>1,435,280.06</u> | <u>1,622,363.15</u> |
| <b>Expenses</b>      |                            |                   |                   |                     |                     |
| 101 336 703.01       | Payroll - Chief            | 7,606.40          | 8,209.62          | 47,540.00           | 49,257.67           |
| 101 336 703.02       | Payroll - Career           | 70,523.81         | 88,800.94         | 467,975.54          | 532,805.69          |
| 101 336 704          | Payroll - Oncall Part Paid | 15,009.42         | 17,916.67         | 93,197.63           | 107,499.98          |
| 101 336 719.01       | Payroll Taxes              | 8,206.91          | 8,944.93          | 45,768.67           | 53,669.61           |
| 101 336 719.02       | Retirement                 | 13,919.92         | 18,196.51         | 65,405.97           | 109,179.05          |
| 101 336 719.03       | Fringe Benefits            | 28,967.99         | 37,318.33         | 153,003.70          | 223,910.02          |
| 101 336 721          | Longevity Pay              | 15,800.00         | 16,800.00         | 15,800.00           | 16,800.00           |
| 101 336 723          | Human Resources Managem    | 113.83            | 416.67            | 2,654.92            | 2,499.98            |
| 101 336 728          | Office Supplies            | 208.90            | 333.33            | 2,152.94            | 1,999.98            |
| 101 336 741          | Repairs & Maintenance      | 5,022.09          | 7,500.00          | 49,845.01           | 45,000.00           |
| 101 336 742          | Apparatus Fuel             | 0.00              | 3,000.00          | 12,512.28           | 18,000.00           |
| 101 336 744          | Uniforms                   | 234.91            | 1,041.67          | 1,906.76            | 5,349.98            |
| 101 336 776          | EMS Supplies               | 2,660.53          | 14,984.21         | 16,616.31           | 89,905.28           |
| 101 336 777          | Building Maintenance       | 205.00            | 1,291.67          | 5,043.00            | 7,749.98            |
| 101 336 800          | Maintenance Supplies       | 358.32            | 250.00            | 2,015.92            | 1,500.00            |
| 101 336 803          | Trash Removal              | 136.33            | 141.67            | 817.98              | 849.98              |
| 101 336 806          | Laundry & Repair           | 825.00            | 2,316.67          | 4,442.41            | 13,899.98           |
| 101 336 817          | Professional Service       | 7,214.97          | 21,609.14         | 137,867.92          | 129,654.81          |
| 101 336 823          | Departmental Programs      | 167.99            | 1,125.00          | 3,748.52            | 6,750.00            |
| 101 336 824          | Training                   | 4,257.00          | 3,958.33          | 19,563.16           | 23,750.02           |
| 101 336 831          | Insurance                  | 6,716.00          | 3,696.50          | 47,300.00           | 22,179.00           |
| 101 336 853          | Communications             | 1,328.82          | 941.67            | 5,772.18            | 5,649.98            |
| 101 336 921          | Utilities                  | 2,151.32          | 2,500.00          | 12,212.51           | 15,000.00           |
| 101 336 940          | Building Rent              | 2,083.33          | 2,083.33          | 12,499.98           | 12,500.02           |
| 101 336 957          | Miscellaneous              | 181.98            | 0.00              | 181.98              | 0.00                |
| 101 901 977.01       | New Equipment              | 0.00              | 1,796.17          | 68,702.31           | 10,777.00           |
| 101 901 977.03       | New Equipment - Ambulanc   | 313,063.00        | 0.00              | 313,063.00          | 0.00                |
| 101 901 977.04       | Debt Service               | 5,827.09          | 5,916.67          | 34,962.54           | 35,499.98           |
| 101 906 995          | Interest Expense           | 0.00              | 0.00              | 83.61               | 0.00                |
|                      | <b>Total Expenses</b>      | <u>512,790.86</u> | <u>271,089.70</u> | <u>1,642,656.75</u> | <u>1,541,637.99</u> |

See Accountant's Report

Grand Ledge Area Emergency Services  
Income Statement  
Compared with Budget  
For the Six Months Ending December 31, 2025

| ID | Description | Current<br>Actual | Current<br>Budget | YTD<br>Actual   | YTD<br>Budget |
|----|-------------|-------------------|-------------------|-----------------|---------------|
|    | Net Income  | \$ (332,951.00)   | \$ (1,362.52)     | \$ (207,376.69) | \$ 80,725.16  |

Grand Ledge Area Emergency Services  
Year to Date Income Statement  
Budget Variance Report  
For the Twelve Months Ending June 30, 2026

| Account ID           | Description                | Current Year Actual | Current Year Budget | Variance              | Variance Percent |
|----------------------|----------------------------|---------------------|---------------------|-----------------------|------------------|
| <b>Revenues</b>      |                            |                     |                     |                       |                  |
| 101 402 001          | GL Millage                 | \$ 408,412.12       | \$ 951,871.22       | (543,459.10)          | (57.09)          |
| 101 402 002          | Oneida Millage             | 260,800.56          | 632,412.38          | (371,611.82)          | (58.76)          |
| 101 402 003          | City DDA Capture           | (129,015.00)        | (258,030.00)        | 129,015.00            | (50.00)          |
| 101 402 004          | GL Millage 2.0             | 319,778.40          | 639,557.75          | (319,779.35)          | (50.00)          |
| 101 402 005          | Oneida Millage 2.0         | 212,457.42          | 424,914.88          | (212,457.46)          | (50.00)          |
| 101 450 001          | Training Income            | 100.00              | 0.00                | 100.00                | 0.00             |
| 101 580 001          | EMS Service Agreement Fee  | 4,000.00            | 4,000.00            | 0.00                  | 0.00             |
| 101 627 001          | Service Runs Billings      | 641,686.02          | 825,000.00          | (183,313.98)          | (22.22)          |
| 101 627 002          | Service Runs Contract W/O  | (256,705.49)        | 0.00                | (256,705.49)          | 0.00             |
| 101 627 003          | Service Runs Bad Debt W/O  | (42,986.09)         | 0.00                | (42,986.09)           | 0.00             |
| 101 664 001          | Interest/Dividend Income   | 16,102.12           | 21,000.00           | (4,897.88)            | (23.32)          |
| 101 671 001          | Miscellaneous Revenue      | 335.00              | 0.00                | 335.00                | 0.00             |
|                      | <b>Total Revenues</b>      | <b>1,434,965.06</b> | <b>3,240,726.23</b> | <b>(1,805,761.17)</b> | <b>(55.72)</b>   |
| <b>Cost of Sales</b> |                            |                     |                     |                       |                  |
|                      | Total Cost of Sales        | 0.00                | 0.00                | 0.00                  | 0.00             |
|                      | <b>Gross Profit</b>        | <b>1,434,965.06</b> | <b>3,240,726.23</b> | <b>(1,805,761.17)</b> | <b>(55.72)</b>   |
| <b>Expenses</b>      |                            |                     |                     |                       |                  |
| 101 336 703.0        | Payroll - Chief            | 51,343.20           | 98,515.39           | (47,172.19)           | (47.88)          |
| 101 336 703.0        | Payroll - Career           | 503,118.39          | 1,065,611.33        | (562,492.94)          | (52.79)          |
| 101 336 704          | Payroll - Oncall Part Paid | 100,521.14          | 215,000.00          | (114,478.86)          | (53.25)          |
| 101 336 719.0        | Payroll Taxes              | 49,257.16           | 107,339.19          | (58,082.03)           | (54.11)          |
| 101 336 719.0        | Retirement                 | 63,637.34           | 218,358.11          | (154,720.77)          | (70.86)          |
| 101 336 719.0        | Fringe Benefits            | 174,503.63          | 447,820.00          | (273,316.37)          | (61.03)          |
| 101 336 721          | Longevity Pay              | 15,800.00           | 16,800.00           | (1,000.00)            | (5.95)           |
| 101 336 723          | Human Resources Managem    | 2,654.92            | 5,000.00            | (2,345.08)            | (46.90)          |
| 101 336 728          | Office Supplies            | 2,152.94            | 3,999.96            | (1,847.02)            | (46.18)          |
| 101 336 741          | Repairs & Maintenance      | 49,845.01           | 90,000.00           | (40,154.99)           | (44.62)          |
| 101 336 742          | Apparatus Fuel             | 12,512.28           | 36,000.00           | (23,487.72)           | (65.24)          |
| 101 336 744          | Uniforms                   | 1,906.76            | 11,600.00           | (9,693.24)            | (83.56)          |
| 101 336 776          | EMS Supplies               | 16,616.31           | 179,810.54          | (163,194.23)          | (90.76)          |
| 101 336 777          | Building Maintenance       | 5,043.00            | 15,500.00           | (10,457.00)           | (67.46)          |
| 101 336 800          | Maintenance Supplies       | 2,015.92            | 3,000.00            | (984.08)              | (32.80)          |
| 101 336 803          | Trash Removal              | 817.98              | 1,700.00            | (882.02)              | (51.88)          |
| 101 336 806          | Laundry & Repair           | 4,442.41            | 27,800.00           | (23,357.59)           | (84.02)          |
| 101 336 817          | Professional Service       | 138,150.45          | 259,309.65          | (121,159.20)          | (46.72)          |
| 101 336 823          | Departmental Programs      | 3,928.52            | 13,500.00           | (9,571.48)            | (70.90)          |
| 101 336 824          | Training                   | 19,563.16           | 47,500.00           | (27,936.84)           | (58.81)          |
| 101 336 831          | Insurance                  | 47,300.00           | 44,358.00           | 2,942.00              | 6.63             |
| 101 336 853          | Communications             | 5,786.97            | 11,300.00           | (5,513.03)            | (48.79)          |
| 101 336 921          | Utilites                   | 12,212.51           | 30,000.00           | (17,787.49)           | (59.29)          |
| 101 336 940          | Building Rent              | 25,000.00           | 25,000.00           | 0.00                  | 0.00             |
| 101 336 957          | Miscellaneous              | 181.98              | 0.00                | 181.98                | 0.00             |
| 101 901 977.0        | New Equipment              | 68,702.31           | 21,554.02           | 47,148.29             | 218.74           |
| 101 901 977.0        | New Equipment - Ambulanc   | 313,063.00          | 0.00                | 313,063.00            | 0.00             |
| 101 901 977.0        | Debt Service               | 69,925.08           | 71,000.00           | (1,074.92)            | (1.51)           |
| 101 906 995          | Interest Expense           | 83.61               | 0.00                | 83.61                 | 0.00             |
|                      | <b>Total Expenses</b>      | <b>1,760,085.98</b> | <b>3,067,376.19</b> | <b>(1,307,290.21)</b> | <b>(42.62)</b>   |

See Accountant's Report

Grand Ledge Area Emergency Services  
 Year to Date Income Statement  
 Budget Variance Report  
 For the Twelve Months Ending June 30, 2026

| Account ID | Description | Current Year Actual | Current Year Budget | Variance     | Variance Percent |
|------------|-------------|---------------------|---------------------|--------------|------------------|
|            | Net Income  | \$ (325,120.92)     | \$ 173,350.04       | (498,470.96) | (287.55)         |

See Accountant's Report

**Grand Ledge Area Emergency Services**  
**Cash Disbursements Journal**  
**For the Period From Dec 1, 2025 to Dec 31, 2025**

Filter Criteria includes: Report order is by Date. Report is printed in Detail Format.

| Date     | Check # | Account ID   | Line Description   | Debit Amount                             | Credit Amount |
|----------|---------|--|--|--|---------------|
| 12/1/25  |         | 101 336 817<br>101 000 003   | Professional Service<br>Pay Plus   | 12.58                                    | 12.58         |
| 12/2/25  |         | 101 336 817<br>101 000 003   | Professional Service<br>Pay Plus   | 27.91                                    | 27.91         |
| 12/3/25  |         | 101 000 229<br>101 000 003   | 941 Taxes EFTPS  | 10,952.56                                | 10,952.56     |
| 12/3/25  |         | 101 336 817<br>101 000 003   | Professional Service<br>Merchant Bankcard<br>Fees  | 370.20                                   | 370.20        |
| 12/3/25  |         | 101 336 817<br>101 000 003   | Professional Service<br>PNC Merchant Fees  | 36.46                                    | 36.46         |
| 12/4/25  |         | 101 336 817<br>101 000 003   | Professional Service<br>Paytrace LLC   | 21.10                                    | 21.10         |
| 12/12/25 |         | 101 000 231.01<br>101 000 202<br>101 000 202<br>101 000 202<br>101 000 003 | P/R Direct Deposit   | 800.00<br>32,284.33<br>1,150.00<br>62.90 | 34,297.23     |
| 12/12/25 | 27488   | 101 000 202<br>101 000 003   | Invoice: 12144<br>Grand Ledge ACE<br>Hardware  | 24.95                                    | 24.95         |
| 12/12/25 | 27489   | 101 000 202<br>101 000 003   | Invoice: 218835<br>AFLAC   | 345.00                                   | 345.00        |
| 12/12/25 | 27490   | 101 000 202<br>101 000 003   | Invoice:<br>11/11-11/25/2025<br>Baryames Cleaners  | 87.70                                    | 87.70         |
| 12/12/25 | 27491   | 101 000 202<br>101 000 003   | Invoice: 86006350<br>Bound Tree Medical,<br>LLC  | 627.25                                   | 627.25        |
| 12/12/25 | 27492   | 101 000 202<br>101 000 003   | Invoice:<br>12/01-12/31/2025<br>Comcast  | 12.67                                    | 12.67         |
| 12/12/25 | 27493   | 101 000 202<br>101 000 202<br>101 000 202<br>101 000 003                   | Invoice:<br>205013878143<br>Invoice:<br>205102845539<br>Invoice:<br>205102845538<br>Consumers Energy | 2.67<br>81.20<br>2,067.45                | 2,151.32      |
| 12/12/25 | 27494   | 101 000 202<br>101 000 003   | Invoice: Eng 611<br>pay051<br>The Dart Bank  | 5,827.09                                 | 5,827.09      |
| 12/12/25 | 27495   | 101 000 202<br>101 000 003   | Invoice: 31558<br>David Chapman<br>Agency, Inc.  | 6,716.00                                 | 6,716.00      |
| 12/12/25 | 27496   | 101 000 202<br>101 000 003   | Invoice: CFSI-19912<br>Fleet Fueling of<br>Michigan  | 2,103.91                                 | 2,103.91      |

**Grand Ledge Area Emergency Services**  
**Cash Disbursements Journal**  
**For the Period From Dec 1, 2025 to Dec 31, 2025**

Filter Criteria includes: Report order is by Date. Report is printed in Detail Format.

| Date     | Check # | Account ID  | Line Description  | Debit Amount                        | Credit Amount |
|----------|---------|---|---|-------------------------------------|---------------|
| 12/12/25 | 27497   | 101 000 202<br>101 000 003  | Invoice: 510362<br>Grand Ledge Auto<br>Parts  | 205.98                              | 205.98        |
| 12/12/25 | 27498   | 101 000 202<br>101 000 202<br>101 000 202<br>101 000 003                | Invoice:<br>10/01-10/31/25 500A<br>Invoice:<br>10/01-10/31/2025<br>500<br>Invoice: W25 11485<br>Hartel<br>City of Grand Ledge | 327.99<br>138.97<br>181.98          | 648.94        |
| 12/12/25 | 27499   | 101 000 202<br>101 000 003  | Invoice: 29577012<br>Granger Container<br>Service, Inc.   | 136.33                              | 136.33        |
| 12/12/25 | 27500   | 101 000 202<br>101 000 003  | Invoice: 385988<br>Greenville Truck &<br>Welding Supply   | 198.05                              | 198.05        |
| 12/12/25 | 27501   | 101 000 202<br>101 000 003  | Invoice: 189958<br>MacDowells   | 150.00                              | 150.00        |
| 12/12/25 | 27502   | 101 000 202<br>101 000 202<br>101 000 202<br>101 000 202<br>101 000 003 | Invoice: W00178<br>Invoice: W50913<br>Invoice: W00317<br>Invoice: W00398<br>MacQueen  | 85.02<br>556.05<br>654.00<br>679.50 | 1,974.57      |
| 12/12/25 | 27503   | 101 000 202<br>101 000 003  | Invoice: 18361<br>Medical Management<br>Systems of MI   | 3,813.37                            | 3,813.37      |
| 12/12/25 | 27504   | 101 000 202<br>101 000 003  | Invoice: 25-1953<br>MI Rescue<br>Resources LLC  | 550.00                              | 550.00        |
| 12/12/25 | 27505   | 101 000 202<br>101 000 003  | Invoice: 1433<br>Mid Michigan Auto<br>Works LLC   | 2,087.00                            | 2,087.00      |
| 12/12/25 | 27506   | 101 000 202<br>101 000 202<br>101 000 003                               | Invoice: T Driver 176<br>Invoice: 913832283 -<br>027<br>Michigan State<br>Disbursement Unit                                   | 336.32<br>499.54                    | 835.86        |
| 12/12/25 | 27507   | 101 000 202<br>101 000 003  | Invoice: pantry<br>121225<br>Grand Ledge<br>Firefighters Local<br>#2627   | 60.00                               | 60.00         |
| 12/12/25 | 27508   | 101 000 202<br>101 000 202<br>101 000 202<br>101 000 003                | Invoice: 162267<br>Invoice: 162266<br>Invoice: 162265<br>Phoenix Safety<br>Outfitters   | 375.00<br>375.00<br>375.00          | 1,125.00      |
| 12/12/25 | 27509   | 101 000 202<br>101 000 003  | Invoice: 2025-2455<br>Riverside<br>Accounting, Inc.   | 1,100.00                            | 1,100.00      |

**Grand Ledge Area Emergency Services  
Cash Disbursements Journal  
For the Period From Dec 1, 2025 to Dec 31, 2025**

Filter Criteria includes: Report order is by Date. Report is printed in Detail Format.

| Date     | Check # | Account ID   | Line Description   | Debit Amount                             | Credit Amount     |
|----------|---------|--|--|--|-------------------|
| 12/12/25 | 27510   | 101 000 202<br>101 000 003   | Invoice: SVA0041635<br>The SHYFT Croup                             | 2,220.00                                 | 2,220.00          |
| 12/12/25 | 27511   | 101 000 202<br>101 000 003   | Invoice: 12/2025<br>Standard Insurance<br>Company                  | 206.04                                   | 206.04            |
| 12/12/25 | 27512   | 101 000 202<br>101 000 003   | Invoice: 00085103-00<br>UM Health - Sparrow<br>Occupational Health | 680.00                                   | 680.00            |
| 12/15/25 |         | 101 336 817<br>101 000 003   | Professional Service<br>Pay Plus                                   | 6.48                                     | 6.48              |
| 12/17/25 |         | 101 000 229<br>101 000 229<br>101 336 719.01<br>101 000 003                | 941 Taxes EFTPS  | 15,669.43<br>0.22                        | 0.22<br>15,669.43 |
| 12/18/25 |         | 101 336 817<br>101 000 003   | Professional Service<br>Pay Plus                                   | 3.47                                     | 3.47              |
| 12/19/25 |         | 101 336 817<br>101 000 003   | Professional Service<br>Pay Plus                                   | 12.58                                    | 12.58             |
| 12/20/25 |         | 101 000 202<br>101 000 202<br>101 000 003                                  | Invoice: swt 111425<br>Invoice: swt 112825<br>State of Michigan    | 1,914.16<br>1,881.82                     | 3,795.98          |
| 12/20/25 |         | 101 000 202<br>101 000 003   | Invoice: 00173511-2<br>MERS  | 14,664.31                                | 14,664.31         |
| 12/26/25 |         | 101 000 231.01<br>101 000 202<br>101 000 202<br>101 000 202<br>101 000 003 | P/R Direct Deposit   | 800.00<br>30,067.84<br>1,150.00<br>76.15 | 32,093.99         |
| 12/26/25 |         | 101 336 817<br>101 000 003   | Professional Service<br>Pay Plus                                   | 3.12                                     | 3.12              |
| 12/26/25 | 27543   | 101 000 202<br>101 000 003   | Invoice: 12238/4<br>Grand Ledge ACE<br>Hardware                    | 6.99                                     | 6.99              |
| 12/26/25 | 27544   | 101 000 202<br>101 000 003   | Invoice: 1002425260<br>Accident Fund<br>Insurance Co of<br>America | 8,470.10                                 | 8,470.10          |
| 12/26/25 | 27545   | 101 000 202<br>101 000 003   | Invoice: 01/2026<br>Ameritas Life<br>Insurance Corp                | 414.40                                   | 414.40            |
| 12/26/25 | 27546   | 101 000 202<br>101 000 003   | Invoice: 3010243<br>Applied Innovation                             | 211.82                                   | 211.82            |
| 12/26/25 | 27547   | 101 000 202<br><br>101 000 003   | Invoice:<br>287294527880x1214<br>25<br>AT&T Mobility               | 752.18                                   | 752.18            |
| 12/26/25 | 27548   | 101 000 202<br>101 000 202   | Invoice: 86019494<br>Invoice: 86021399                             | 780.34<br>201.70                         |                   |

### Grand Ledge Area Emergency Services Cash Disbursements Journal For the Period From Dec 1, 2025 to Dec 31, 2025

Filter Criteria includes: Report order is by Date. Report is printed in Detail Format.

| Date     | Check # | Account ID                 | Line Description  | Debit Amount     | Credit Amount |
|----------|---------|----------------------------|---|------------------|---------------|
|          |         | 101 000 003                | Bound Tree Medical, LLC                                 |                  | 982.04        |
| 12/26/25 | 27549   | 101 000 202<br>101 000 003 | Invoice: 10007125<br>Boynton Fire Safety Service        | 205.00           | 205.00        |
| 12/26/25 | 27550   | 101 000 202<br>101 000 003 | Invoice: 1004344<br>Clark Hill PLC                      | 124.00           | 124.00        |
| 12/26/25 | 27551   | 101 000 202<br>101 000 003 | Invoice: 356312<br>CobraHelp                            | 27.00            | 27.00         |
| 12/26/25 | 27552   | 101 000 202<br>101 000 003 | Invoice:<br>12/21-01/20/2026<br>Comcast                 | 298.39           | 298.39        |
| 12/26/25 | 27553   | 101 000 202<br>101 000 003 | Invoice: 72816<br>CSI Emergency Apparatus, LLC          | 859.98           | 859.98        |
| 12/26/25 | 27554   | 101 000 202<br>101 000 003 | Invoice:<br>01/01-01/31/2026<br>Delta Dental            | 1,404.94         | 1,404.94      |
| 12/26/25 | 27555   | 101 000 202<br>101 000 003 | Invoice: 1016<br>Eaton County Training Committee        | 2,440.00         | 2,440.00      |
| 12/26/25 | 27556   | 101 000 202<br>101 000 003 | Invoice:<br>11/06-12/04/2025<br>Elan Financial Services | 2,051.80         | 2,051.80      |
| 12/26/25 | 27557   | 101 000 202<br>101 000 003 | Invoice: 369202<br>Fire.Com                             | 183.33           | 183.33        |
| 12/26/25 | 27558   | 101 000 202<br>101 000 003 | Invoice: 386893<br>Greenville Truck & Welding Supply    | 133.80           | 133.80        |
| 12/26/25 | 27559   | 101 000 202<br>101 000 003 | Invoice: 2025-GL01<br>Brian Kazmierzak                  | 1,800.00         | 1,800.00      |
| 12/26/25 | 27560   | 101 000 202<br>101 000 003 | Invoice: E00007<br>MacQueen                             | 313,063.00       | 313,063.00    |
| 12/26/25 | 27561   | 101 000 202<br>101 000 003 | Invoice: 76719<br>Maner Costerisan                      | 3,150.00         | 3,150.00      |
| 12/26/25 | 27562   | 101 000 202<br>101 000 003 | Invoice: 10613<br>McGinty, Hitch, Person, Anderson      | 1,877.50         | 1,877.50      |
| 12/26/25 | 27563   | 101 000 202<br>101 000 003 | Invoice: 1531<br>Mid Michigan Auto Works LLC            | 86.86            | 86.86         |
| 12/26/25 | 27564   | 101 000 202<br>101 000 003 | Invoice:<br>01/01-12/31/2026<br>State of Michigan       | 180.00           | 180.00        |
| 12/26/25 | 27565   | 101 000 202<br>101 000 202 | Invoice: T Driver 177<br>Invoice: 913832283 -<br>000    | 336.32<br>499.54 |               |

**Grand Ledge Area Emergency Services  
Cash Disbursements Journal  
For the Period From Dec 1, 2025 to Dec 31, 2025**

Filter Criteria includes: Report order is by Date. Report is printed in Detail Format.

| Date     | Check #      | Account ID     | Line Description                           | Debit Amount      | Credit Amount     |
|----------|--------------|----------------|--|-------------------|-------------------|
|          |              | 101 000 003    | 028<br>Michigan State<br>Disbursement Unit |                   | 835.86            |
| 12/26/25 | 27566        | 101 000 202    | Invoice: pantry<br>122625                  | 60.00             |                   |
|          |              | 101 000 003    | Grand Ledge<br>Firefighters Local<br>#2627 |                   | 60.00             |
| 12/26/25 | 27567        | 101 000 202    | Invoice: 153486-2                          | 375.00            |                   |
|          |              | 101 000 202    | Invoice: 162667                            | 375.00            |                   |
|          |              | 101 000 202    | Invoice: 162791                            | 320.00            |                   |
|          |              | 101 000 003    | Phoenix Safety<br>Outfitters               |                   | 1,070.00          |
| 12/26/25 | 27568        | 101 000 202    | Invoice: 231736                            | 513.45            |                   |
|          |              | 101 000 003    | VC3, Inc.                                  |                   | 513.45            |
| 12/29/25 |              | 101 336 817    | Professional Service                       | 24.84             |                   |
|          |              | 101 000 003    | Pay Plus                                   |                   | 24.84             |
| 12/31/25 |              | 101 000 229    |  | 10,868.37         |                   |
|          |              | 101 000 003    | 941 Taxes EFTPS                            |                   | 10,868.37         |
| 12/31/25 |              | 101 336 817    | Professional Service                       | 40.00             |                   |
|          |              | 101 000 003    | The Dart Bank                              |                   | 40.00             |
| 12/31/25 |              | 101 336 817    | Professional Service                       | 70.59             |                   |
|          |              | 101 000 003    | The Dart Bank                              |                   | 70.59             |
| 12/31/25 |              | 101 000 231.01 |  | 1,735.66          |                   |
|          |              | 101 000 003    | MERS HCSP                                  |                   | 1,735.66          |
|          | <b>Total</b> |                |  | <b>499,796.55</b> | <b>499,796.55</b> |